

**NEW!**

# Emerald TurboVap DX Series

## Reduced Size, Noise & Amperage



TVE12-230V shown



**The Emerald TurboVap series of split-system evaporators incorporates revolutionary design features with mechanical engineering that maximizes the effectiveness of R-410A, an environmentally safe refrigerant.**

Emerald TurboVaps are easy to install. For ideal positioning, the high-velocity blower can rotate up to 270 degrees with a single adjustment screw. The enclosed motor means no blower-motor overhang for a compact design.

Since evaporators are usually positioned in or near cabins, noise is always a concern. The Emerald TurboVap uses a vibration-isolation mounting system to minimize noise, so the evaporator runs more quietly. The fully insulated, high-velocity blowers are quiet and efficient.

Excellent condensate drainage is achieved with a unique positive-flow, anti-slosh, composite drain pan that is rust-free. Condensate water is rapidly removed at one of two easy-to-plumb drain locations.

The Emerald TurboVap Series was designed to operate as a system with the Emerald Condenser Series. Both of these split-system components were engineered to harness and maximize the superior thermodynamic properties of the environmentally safe R-410A refrigerant.

The Emerald TurboVap is available in six capacities ranging from 4,000 to 16,000 BTU/hr.

*Rust-free molded composite drain pan reduces standing water – 2 oz. (59 ml) vs. 16 oz. (473 ml) in ordinary pans. Innovatively engineered “positive flow” drain channels prevent the sloshing and spilling of condensate — even in the roughest seas.*



### Key Benefits

- Up to 28% reduced amperage.
- Up to 85% reduction of standing water in the drain pan.
- Up to 14% increase in cooling capacity.
- Up to 15% reduced weight.
- Up to 17% reduction in height.
- Up to 19% increased air flow CFM.
- Positive-flow, anti-slosh, rust-free drain pan ensures condensate does not spill.
- Installation time reduced by 15 minutes.
- Single screw for 270° blower rotation.
- No blower-motor overhang reduces depth.
- Vibration-isolation mounting system reduces noise.
- Pair it with an Emerald Condenser for maximum performance.
- Available in 4K, 6K, 8K, 10K, 12K, and 16K BTU/hr capacities.
- 115V or 230V models.
- Engineered to maximize thermodynamic properties of R-410A, an environmentally safe refrigerant.

# Technical Specifications for Emerald TurboVap DX Evaporators

Model <sup>(1)</sup>	TVE4		TVE6		TVE8		TVE10		TVE12		TVE16	
Capacity BTU/hr	4,000		6,000		8,000		10,000		12,000		16,000	
Voltage (VAC) @ 50-60Hz/1 Ph	115	230	115	230	115	230	115	230	115	230	115	230
Full Load Amps Blower (FLA)	0.8	0.41	0.8	0.41	1.56	0.83	1.14	0.61	1.14	0.61	1.61	0.78
K.V.A. (Kilo-Volt-Amps)	0.09	0.09	0.09	0.09	0.18	0.19	0.13	0.14	0.13	0.14	0.19	0.18
Suggested Circuit Breaker (Amps)	2.0	1.0	2.0	1.0	4.0	2.0	3.0	1.0	3.0	1.0	4.0	2.0
<b>Unit Dimensions (in/mm)</b>												
Height – Evaporator (H1)	10.8/274		10.8/274		10.8/274		12.6/320		12.6/320		13.0/330	
Height – Blower (H2) <sup>(2)</sup>	10.2/259		10.2/259		11.4/290		12.4/315		12.4/315		13.6/345	
Width	12.3/312		12.3/312		12.3/312		14.3/36.3		14.3/36.3		14.3/36.3	
Depth	9.5/241		9.5/241		9.4/239		10.4/264		10.4/264		11.6/295	
Min. Duct Size Ø	4.0/102		4.0/102		5.0/127		6.0/152		6.0/152		7.0/178	
Min. Supply Air Grille (sq. in./cm.)	32/206		32/206		48/310		60/387		70/452		81/523	
Min. Return Air Grille (sq. in./cm.)	64/413		64/413		80/516		110/710		130/839		160/1032	
Net Weight (lbs./kg.)	10.5/4.8		11.0/5.0		14.0/6.4		17.5/7.9		17.5/7.9		20.5/9.3	
Gross Weight (lbs./kg.)	18.5/8.4		19.0/8.6		22.0/10.0		25.5/11.6		25.5/11.6		28.5/12.9	

**Notes:**

- <sup>(1)</sup> End all model numbers with a '115V' or '230V' depending on the selected voltage.
- <sup>(2)</sup> Add 2.0"/51mm to the height dimension to allow for the duct ring (not included) when the blower is installed in the vertical position.

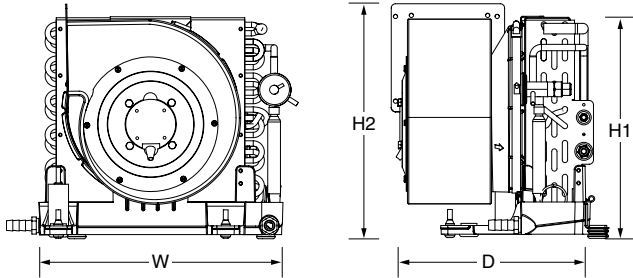

*Emerald TurboVap 12K unit shown with optional lineset extensions.*

## Typical Installation of a Split A/C System

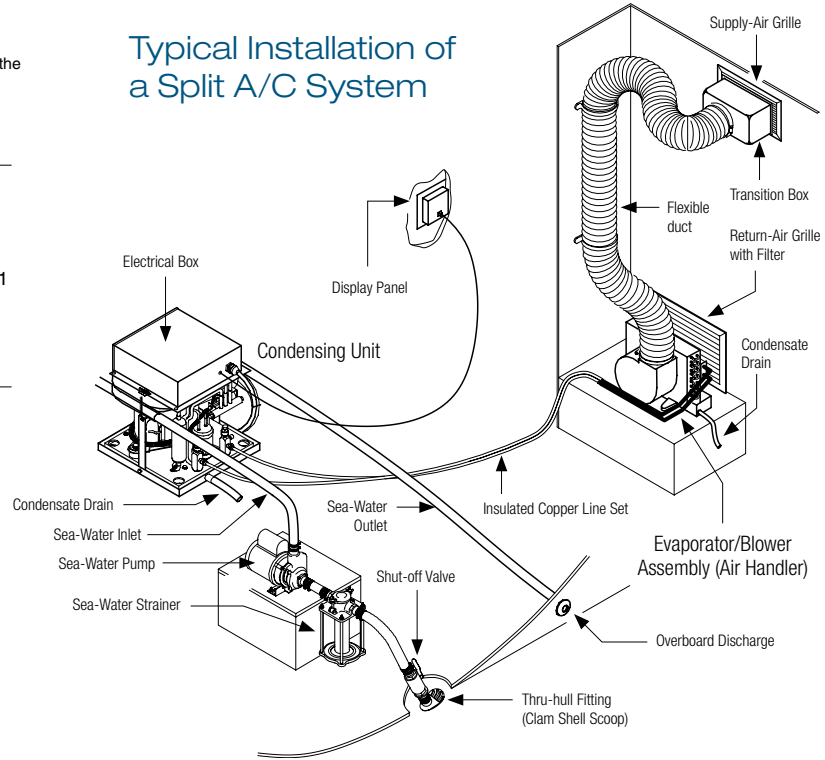

Dealer:

**DOMETIC MARINE**  
 2000 N. Andrews Ave. Ext. I Pompano Beach, FL 33069 USA | 954-973-2477 | Fax 954-979-4414  
 www.DometicUSA.com | MarineSales@DometicUSA.com

**United States & Canada Tech Support**  
 8:00 AM to 5:00 PM Eastern Time: 800-542-2477  
 After hours and weekends: 888-440-4494

**International Sales & Service:**  
 Europe & the Middle East: Call +44(0)870-330-6101  
 For all other areas visit our website to find your nearest distributor.