

Turbo Self-Contained Series

Powerful, Compact, and Quiet Cold Air



VTD14K Vector Turbo shown with optional Sound Shield

Rust-free molded composite drain pan designed for quick removal of condensate water. Innovatively designed sloped channels route water rapidly to a choice of three easy-to-plumb drain locations.

Experience better noise reduction with a built-in cushion system that minimizes vibration to the deck. Additionally, the innovative mounting clips utilize vibration isolators. As shown in the photo, the optional molded compressor sound shield maximizes noise containment.

The enclosed motor eliminates overhang, and the high-velocity blower can be rotated through 270° with one adjustment screw. The unit's unique inlet ring is designed to optimize air flow and ensure that the height of the unit does not increase when the blower rotates.

Easy-to-install sound covers reduce noise by up to 50%



These compact, easy-to-install sound covers are available for all Vector Turbo models. The cover fits over the compressor, providing a 3- to 5-dB noise reduction—which is about a 50% drop in what the human ear can perceive. Installation takes just minutes and all mounting hardware is included.

Key Benefits

- Up to 27% more energy efficient.
- Up to 21% increased capacity.
- Compact design uses less space.
- Rust-free drain pan.
- Up to 85% less standing water in the drain pan.

Technical Specifications for Turbo Self-Contained Air Conditioning System

Model	VTD6K			VTD8K			VTD10K			VTD12K			VTD14K			VTD16K		
	6,000			8,000			10,000			12,000			14,000			16,000		
Capacity (BTU/hr)	115	220-240	115	230	220-240	115	230	220-240	115	230	220-240	115	230	220-240	115	230	220-240	
Voltage (VAC)	60	1	50	1	60	1	60	1	60	1	60	1	60	1	60	1	60	1
Cycle (Hz)/Phase (Ph)	3.8	2.1	5.4	2.6	3.6	6.0	3.1	3.4	6.8	3.4	3.7	7.8	4.2	4.4	9.4	4.6	4.5	
Full Load Amps (FLA) cool	5.0	2.8	7.0	3.4	4.4	8.3	4.2	4.3	9.4	4.7	4.7	11.3	5.4	5.8	12.4	6.2	5.8	
Full Load Amps (FLA) heat	29	11	40	19	20	42	21	16.9	53	26	22.2	58	33	22	59	34	32	
Locked Rotor Amps (Comp)	0.6	0.7	0.8	0.8	1.1	1.0	1.0	1.0	1.1	1.1	1.1	1.3	1.3	1.4	1.4	1.4	1.4	
K.V.A. (Kilo-Volt-Amps)	15	9	21	10	13	25	14	13	31	15	15	33	18	18	40	21	19	
Max. Circuit Breaker (Amps)	9	5	12	6	8	14	8	8	17	9	8	19	10	10	23	12	11	
Min. Circuit Ampacity (Amps)	8	227	10	283	10	283	10.5	298	11	312	11	312	13	369	13	369	13	369
Refrigerant R-22 (oz/g)																		
Unit Dimensions (in/cm)																		
Height – Evaporator (C ¹)	10.8	27.4	10.8	27.4	27.4	12.2	31.0	31.0	12.2	31.0	31.0	12.9	32.8	32.8	12.9	32.8	32.8	
Height – Compressor (D ¹)	12.2	31.0	12.2	31.0	31.0	13.0	32.9	32.9	13.0	32.9	14.2	36.1	36.1	14.2	36.1	14.2	36.1	
Height – w/opt. Sound Cover	13.0	33.0	13.0	33.0	33.0	13.5	34.3	34.3	13.5	34.3	15.0	38.1	38.1	15.0	38.1	15.0	38.1	
Width (A ¹)	17.6	44.7	17.6	44.7	44.7	20.4	51.8	51.8	20.4	51.8	20.4	51.8	21.4	54.4	21.4	54.4	54.4	
Depth (B ¹)	10.7	27.2	10.7	27.2	27.2	12.4	31.5	31.5	12.4	31.5	12.4	31.5	13.3	33.8	13.3	33.8	33.8	
Min. Duct Size Dia.	4	10.2	5	12.7	12.7	6	15.2	15.2	6	15.2	6	15.2	7	17.8	7	17.8	17.8	
Min. SA Grill (sq in/cm)	32	206	48	310	310	60	387	387	70	452	452	76	490	490	80	523	523	
Min. RA Grill (sq in/cm)	64	413	80	516	516	100	710	710	130	839	839	144	929	929	160	1082	1082	
Net Weight (lbs/kg)	39.6	18.0	40.4	18.3	43.8	19.9	43.6	19.8	48.8	22.1	48.8	22.1	52.8	24.0	54.4	24.7	55.0	24.9
Gross Weight (lbs/kg)	49.6	22.5	50.4	22.9	53.8	24.4	53.6	24.3	58.8	26.7	58.8	26.7	62.8	28.5	64.4	29.2	65.0	29.5

Notes:

- 1) Add a 'Z' or 'Z50' after the capacity designator for 230V or 220-240V/50Hz units respectively. Examples VTD8K = 115V, VTD8Z=230V, VTD8Z50=220-240V/50Hz
- 2) BTU and electrical data are based on a 45°F/7.2°C evaporator and 100°F/37.8°C condenser in cool mode, and a 45°F/7.2°C evaporator and 130°F/54.4°C condenser in heat.
- 3) Note: 60Hz units must not operate at 50Hz and 50Hz units must not operate at 60Hz.
- 4) Refrigerant charges shown are for R22. Alternative "Environmentally Friendly Green Gas" refrigerants available on request.
- 5) Electric box is remote mounted up to 34" (86cm) away from compressor. E-box dimensions are 2.7" (6.9cm) x 6.5" (16.5cm) x 8.8" (22.4cm).

† Refers to callouts shown in drawing below.

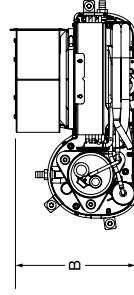

Mounting brackets included
Condensate drain fitting included

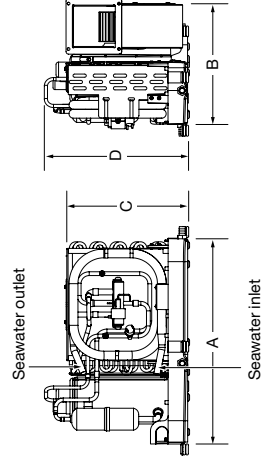

Dealer:

DOMETIC MARINE
2000 N. Andrews Ave. Ext. I Pompano Beach, FL 33069 USA | 954-973-2477 | Fax 954-979-4414
www.dometic.com

United States & Canada Service Hours:
8:00 AM to 5:00 PM Eastern Time

24/7 AC SERVICE HOTLINE: 5:00PM to 8:00 AM: 888-440-4494

International Sales & Service:
Europe & the Middle East: Call +44(0)870-330-6101
For all other areas visit our website to find your nearest distributor.

L-2502MC Rev. 20090327



Dometic
MARINE