

SKYVENETIAN 50mm Wood slat

Order Form and Product Guide

Customer _____
 Address _____

Tel _____
 Mobile _____
 Email _____

Order _____ Quote _____ Date _____
 Project Name _____
 Project Location _____

Are any of the blinds on this order to be installed where children under 42 months old are likely to be allowed? ² Yes No

Window ID	Dimension Info	Slat	Head rail Options	Restraint Options	Manual Control Options <i>Please choose one only</i>						Powered Control Options	Qty
					Option 1 Cord Loop ³		Option 2 Lift & Tilt					
	Type Recess ¹ Blind	Colour	Type 50 mm	Free hanging	Position: Left Right	Position Left Right	Tilt Cord <i>(At opposite end to lift cord)</i>	Motor Code				
Location	Width (X)	Ladder	Powered Only LTWN	Guide wire	Length (mm): ⁴	Acorn Type	Tilt wand Position	Wire exit point:	Left	Right		
	Drop (Y)	String	Fixing Top Face	Chrome dome Nickel dome Chrome flush Black flush Nickel flush	400 500 700 1000	Square (default) Round	Left Right	Left	Right			
	Installation height ²	Tape: 24 mm 38 mm	Colour	Sidetrack	Cord Colour		Type	Switches				
				Sidetrack colour White Black Custom	Black Grey Fawn White	Metal Cord Tidy <i>(With black or white rubber insert)</i>	Metal Lift Cord Cleat <i>(With black or white rubber insert)</i>	Rubber Wood	Transformers or Controls Required	Yes ⁵	No	
			Valance	RAL Ref	Chrome - Black White Nickel - Black White	Chrome - Black White Nickel - Black White	Length mm 150 300 1000					
			Yes No				Custom Length					

Notes

- If recess size is specified the blind will be made X minus 10 mm [3/8"] and Y minus 5mm [1/4"].
- Installation height required for cord operated blinds. EN13120 Standards demand the distance from the floor to the bottom of the pull cord(s) shall be at least 1500 mm [59 1/16"]. and a cord collection device (cleat) is fitted at or above this height. We can only supply blinds meeting these conditions unless the above question has been answered No.
- Cord Loop is supplied with a cord tidy child safety device as standard, please select colour.
- Installation height less cord length must be greater than 1500 mm [59 1/16"].
- Please fill in a Powered Accessories Order Form, download from [here](#).
- Specialist motor please contact manufacturer before ordering.

A selection of simple shapes are available, please contact manufacturer for more details.

Wood Venetian blinds are not suitable in areas of high humidity, toilets, bathrooms or wet rooms. Please consult manufacturer regarding alternative solutions for these areas.

Motor codes & specifications (Other motors available please contact manufacturer for details)

Voltage	Motor Code	Description	Switched (SW) or remote controlled (R)	Torque Nm	RPM	Min width X (mm)	Max drop Y(mm)	Head rail size	
								50mm	TWIN
12v DC	25SD1	Atlantic 125 - 12v Double End	SW	1.2	32	550mm [21 5/8"]*	3250 mm [127 15/16"]	✓	N/A
24v DC	25SD2	Atlantic 245 - 24v Double End	SW	1.2	32	550mm [21 5/8"]*	3250 mm [127 15/16"]	✓	N/A
24v DC	24	Somfy Lw25-B83	SW	1	30	662 mm [26 1/16"]	3250 mm [127 15/16"]	✓	N/A
24v DC	LTWN	Lutron Twin	See note 6	See note 6	See note 6	624 mm [24 9/16"]	3250 mm [127 15/16"]	N/A	✓
24v DC	S30D / S30R	Somfy Sonesse 30 DCT / RTS	SW / R	2	28	616 mm [24 1/4"]	TBC	✓	N/A
230v AC	S40W/ S40R	Somfy Sonesse 40 WT / RTS	SW / R	9	12	616 mm [24 1/4"]	TBC	✓	N/A
230v AC	40W4	Pacific 230R WT 230v AC	SW	10	16	616 mm [24 1/4"]	3250 mm [127 15/16"]	✓	N/A

* Blinds with a drop (Y) greater than 1600mm [63"] will have a Min X: 630mm [24 1/16"]

Internal use only Customised



SKYVENETIAN 50mm Wood slat

Order Form and Product Guide

Cleats



Mandatory child safety device
 Fix to an adjacent wall. Secure cord after every operation of blind.
 Available in Chrome or Brushed Nickel with either a White or Black rubber insert.



Cord Tidy



Mandatory child safety device
 Fix to an adjacent wall, ensures taut chain or continuous cord.
 Available in Chrome or Brushed Nickel with either a White or Black rubber insert.



Cord connector



Mandatory child safety device for manual blinds
 Best matched to slat colour
 Black
 White
 Breaks under horizontal force, releasing cords.



Tilt Wand

Used to tilt the blind slats
 Colours:
 Black Blue Grey
 Beige White



Wood Tilt Wand

Colours:
 Black Golden Oak Red Mahogany
 Cherry Honey Oak Teak
 Dark Mahogany Maple White
 Ebony Natural USA Walnut
 European Walnut Off White



Acorns

Wooden Square or Round
 Standards Colours:

- | | | |
|-----------------|-----------------|-----------|
| Black | Red Mahogany | Maple |
| Ebony | American Walnut | Natural |
| European Walnut | Cherry | Off White |
| Dark Mahogany | Honey Oak | White |



Guide wire Hold down options

Dome: Chrome or Brushed Nickel
 Flush Mounted: Chrome, Brushed Nickel or Black



Valance

Front facing Valance will be automatically colour and size matched based on order

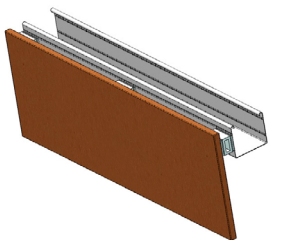

Head rail Colour Options

		VB50	TWIN
Standard Colour	White	✓	✓
	China White	✓	
	Black	✓	
	Brown	✓	
	Beige	✓	

Custom colours are available, contact manufacturer for more details

