



RECORD THIS INFORMATION FOR FUTURE
REFERENCE:

Model Number _____
Serial Number _____
Date Purchased _____
Retailer / Qualified Installer _____

USA
SERVICE OFFICE
Dometic Corporation
1120 North Main Street
Elkhart, IN 46514

CANADA
Dometic Corporation
46 Zatonski, Unit 3
Brantford, ON N3T 5L8
CANADA

**SERVICE CENTER &
DEALER LOCATIONS**
Please Visit:
www.eDometic.com

3313943.000 REMOTE WALL CONTROL KIT

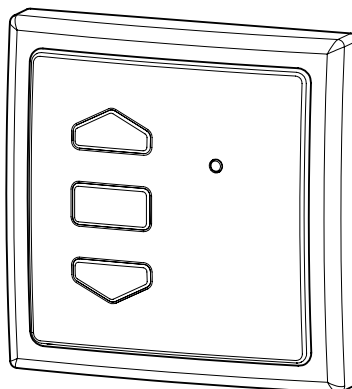

INSTALLATION & OPERATING INSTRUCTIONS

3313943.000
REMOTE WALL
CONTROL KIT

REVISION A
Form No. 3314042.000 12/16
(French 3314043.000_A)
©2016 Dometic Corporation
LaGrange, IN 46761

Important: These Instructions must
stay with unit. Owner read carefully.

GENERAL INSTRUCTIONS

These instructions apply to:

202(XX)(XX).000(#) 9500E Cassette Awnings
203(XX)(XX).000(#) DA20(XX) Cassette Awnings

This kit consists of:

- (1) Installation & Operating Instructions
- (1) Awning Remote Wall Control Unit with Base

Dometic Corporation reserves the right to modify appearances and specifications without notice.

2. On back of remote wall control unit, place and slide battery into battery clip until fully engaged. See FIG. 2.

Note: Make sure battery has positive side up.

FIG. 2

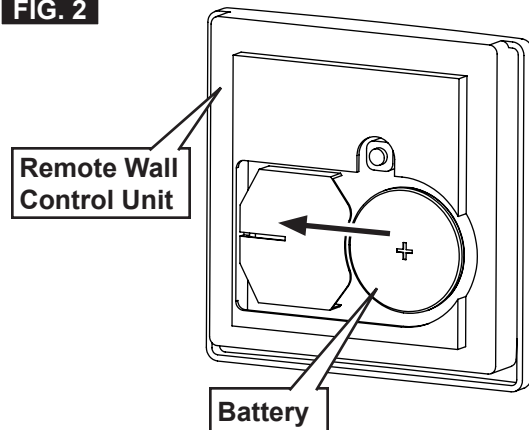

PROCEDURE

A. Install Remote Wall Control Unit

NOTICE

Do not expose remote and remote holster to weather, extreme temperatures, or long hours in direct sunlight. Failure to obey this notice could result in property damage.

1. Locate a suitable location for remote wall control base that's protected from weather and other adverse conditions, and install with two screws. See FIG. 1.

FIG. 1

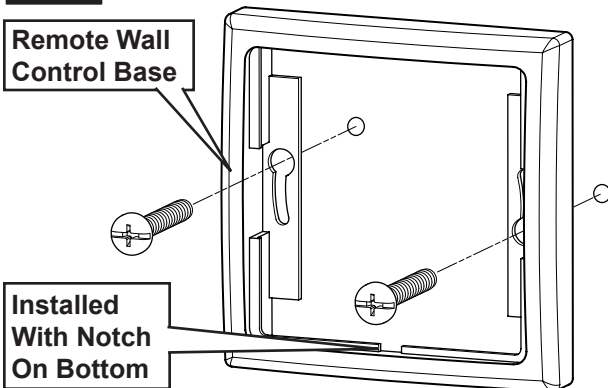

B. Activate Remote Wall Control Unit

More than one remote may be added to operate the awning if desired.

Note: Refer to the operating instructions that came with your awning if this remote is a replacement, and no other remote is programmed to the awning.

1. Make sure power is supplied to awning motor.

Note: There should already be at least one remote programmed to the awning motor at this stage.

2. Using a remote that already controls the awning motor, press and hold the program button on back for approximately (3) seconds. Awning motor should jog momentarily. See FIG. 3.

FIG. 3

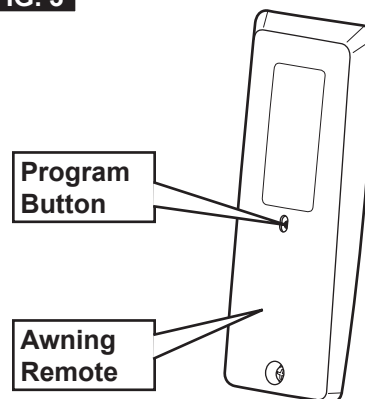

3. Press and hold the program button on back of remote wall control unit for approximately (3) seconds. Awning motor should jog momentarily. See FIG. 4.

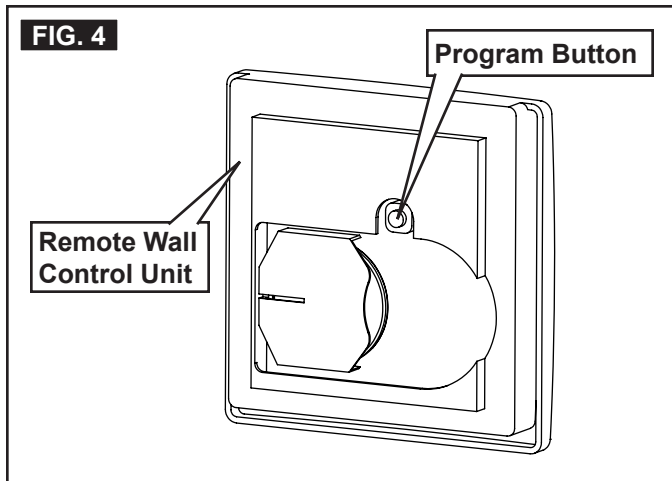

5. Install the remote wall control unit onto remote wall control base by snapping it in place. See FIG. 6.

Note: To remove remote wall control unit from base, use flat bladed screw driver to disengage tab at bottom notch. See FIG. 1.

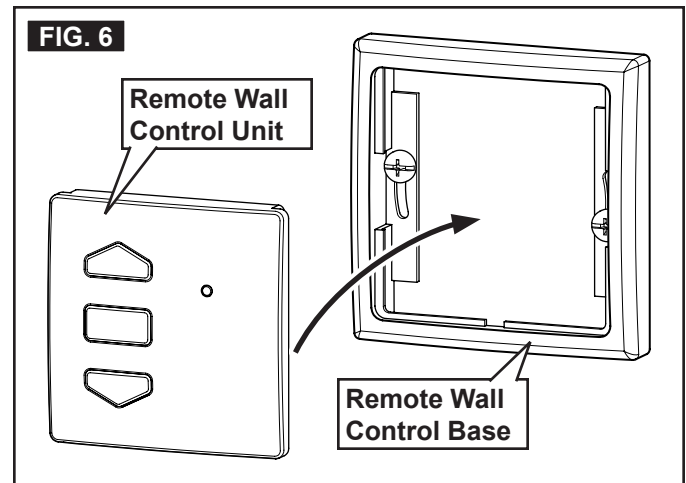

4. Verify awning motor and remote functionality.
 - a. Press the open button (down arrow) briefly on awning remote wall control unit. Awning should extend to its out limit. See FIG. 5.

Note: If awning does not respond, verify LED lights momentarily (on remote wall control unit) when button is pressed. If LED does not light, install new batteries.

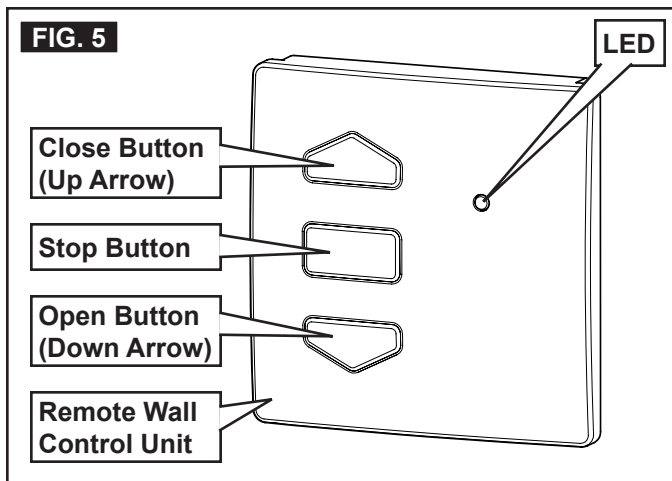

C. Operate Remote

1. See "Procedure" under awning Operating Instructions for specific operating information.