

↗ DOMETIC

REFRIGERATION

RU

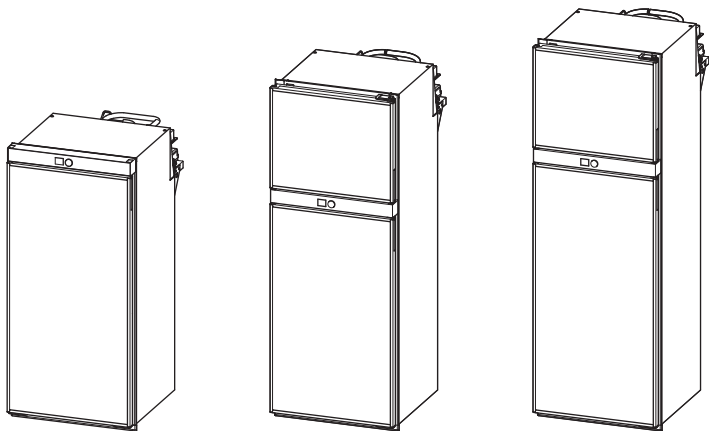

RUC5208X, RUC6408X, RUC8408X

EN

Compressor refrigerator

Installation and Operating Manual

© 2024 Dometic Group. The visual appearance of the contents of this manual is protected by copyright and design law. The underlying technical design and the products contained herein may be protected by design, patent or pending patent. The trademarks mentioned in this manual belong to Dometic Sweden AB. All rights are reserved.

Please read these instructions carefully and follow all instructions, guidelines, and warnings included in this product manual in order to ensure that you install, use, and maintain the product properly at all times. These instructions **MUST** stay with this product.

By using the product, you hereby confirm that you have read all instructions, guidelines, and warnings carefully and that you understand and agree to abide by the terms and conditions as set forth herein. You agree to use this product only for the intended purpose and application and in accordance with the instructions, guidelines, and warnings as set forth in this product manual as well as in accordance with all applicable laws and regulations. A failure to read and follow the instructions and warnings set forth herein may result in an injury to yourself and others, damage to your product or damage to other property in the vicinity. This product manual, including the instructions, guidelines, and warnings, and related documentation, may be subject to changes and updates. For up-to-date product information, please visit dometic.com.

Contents

1	Explanation of symbols	3
2	Safety instructions	4
3	Safety when installing	5
4	Scope of delivery	7
5	Accessories	7
6	Intended use	7
7	Technical description	8
8	Installation	15
9	Connecting the refrigerator	26
10	Using the refrigerator	27
11	Cleaning and maintenance	48
12	Troubleshooting	50
13	Warranty	53
14	Disposal	54
15	Technical data	55

1 Explanation of symbols



DANGER!

Safety instruction: Indicates a hazardous situation that, if not avoided, will result in death or serious injury.



WARNING!

Safety instruction: Indicates a hazardous situation that, if not avoided, could result in death or serious injury.



CAUTION!

Safety instruction: Indicates a hazardous situation that, if not avoided, could result in minor or moderate injury.

**NOTICE!**

Indicates a situation that, if not avoided, can result in property damage.

**NOTE**

Supplementary information for operating the product.

2 Safety instructions

2.1 General safety



WARNING! Failure to obey these warnings could result in death or serious injury.

Electrocution hazard

- Installation and removal of the refrigerator may only be carried out by qualified personnel.
- Do not operate the refrigerator if it is visibly damaged.
- This refrigerator may only be repaired by qualified personnel. Improper repairs can result in considerable danger or damage to the refrigerator.
- If this refrigerator's power cable is damaged, it must be replaced by the manufacturer, a service agent or a similarly qualified person in order to prevent safety hazards.
- When positioning the refrigerator, ensure the supply cord is not trapped or damaged.
- If the device is powered by the mains, ensure that the power supply has a residual current circuit breaker (RCCB) or a ground fault circuit interrupter (GFCI). Installation, especially in potentially damp areas, must be in accordance with all applicable installation regulations.

Fire hazard

- The insulation of the refrigerator contains flammable cyclopentane and requires special disposal procedures. Deliver the refrigerator at the end of its life-cycle to an appropriate recycling center.

Explosion hazard

- Do not store any explosive substances, such as aerosol cans with propellants, in the refrigerator.

Health hazard

- This refrigerator is not intended for use by persons (including children) with reduced physical, sensory or mental capabilities, or lack of experience and knowledge, unless they have been given supervision or instruction concerning use of the refrigerator by a person responsible for their safety.
- Children aged from 3 to 8 years are allowed to load and unload the refrigerator.
- Cleaning and user maintenance shall not be made by children without supervision.
- Children must be supervised to ensure that they do not play with the refrigerator.

Risk of child entrapment

- Ensure that the shelves are mounted and secured so that children cannot lock themselves in the refrigerator.
- Before disposing of your old refrigerator:
 - Dismantle the drawers.
 - Leave the shelves in the refrigerator so that children cannot climb inside.
 - Take off the doors.



CAUTION! Failure to obey these cautions could result in minor or moderate injury.

Health hazard

- To avoid a hazard due to instability of the refrigerator, it must be fixed in accordance with the installation instructions.
- Keep ventilation openings, on the refrigerator and in its enclosure or in the built-in structure, clear of obstruction.

- Do not use mechanical devices or other means to accelerate the defrosting process, other than those recommended by the manufacturer.
- Do not open or damage the refrigerant circuit under any circumstances.
- Do not use electrical devices inside the refrigerator unless they are recommended by the manufacturer for that purpose.

Risk of injury

- DO NOT USE OR STORE FLAMMABLE MATERIALS IN OR NEAR THIS REFRIGERATOR.
- DO NOT PLACE ARTICLES ON OR AGAINST THIS REFRIGERATOR.
- DO NOT MODIFY THIS REFRIGERATOR.

**NOTICE! Damage hazard**

- Keep the condensate drain clean at all times.
- Do not use a high-pressure cleaner near the ventilation grille when cleaning the vehicle.
- The refrigerator may not be exposed to rain.

3 Safety when installing

The electrical installation must comply with national and local regulations including AS/NZS 3000 and AS/NZS 3001.2 – Electrical installations.

**WARNING! Failure to obey these warnings could result in death or serious injury.****Fire hazard**

- Keep the installation recess for the refrigerator free of any electrical components and luminaires which during normal or abnormal operation produce sparks or arcs (i.e. relays or fuse boxes).
- Ensure clean and residue-free handling if silicon sealant or similar is used. There is a risk of fire if silicone filaments come into contact with hot parts or naked flames.
- Do not install the refrigerator near naked flames or other heat sources (heaters, direct sunlight, gas ovens etc.).
- After installation, it must still be possible to disconnect the refrigerator from the supply mains. This may be achieved by having the plug accessible or by incorporating a switch in the fixed wiring according to the wiring rules.

**CAUTION! Failure to obey these warnings could result in death or serious injury.****Risk of injury**

- Do not put your fingers into the hinge.

**NOTICE! Damage hazard**

- Check that the voltage specification on the data plate is the same as that of the power supply.
- During transport, only touch the refrigerator by the refrigerator housing. Never touch the refrigerator by the compressor unit, the cooling fins, the door or the control panel.
- Only carry the refrigerator upright. Never transport the device in a horizontal position, so that lubricating oil does not drain from the compressor into the pipes.
- Protect the refrigerator and the cabling against heat and moisture. Do not place the refrigerator near heat sources (heaters, direct sunlight, gas ovens, etc.).

Risk of overheating!

Always ensure sufficient ventilation so that the heat generated during operation can dissipate. Make sure that the device is sufficiently far away from walls and other objects so that the air can circulate.

3.1 Safety when operating



CAUTION! Failure to obey these cautions could result in minor or moderate injury.

Health hazard

- Ensure that foodstuffs do not touch the walls of the cooling area.
- Clean regularly surfaces that can come in contact with food and accessible drainage systems.
- Store raw meat and fish in suitable containers in the refrigerator, so that it is not in contact with and cannot drip onto other food.
- If the refrigerator is left empty for long periods:
 - Switch off the refrigerator.
 - Defrost the refrigerator.
 - Clean and dry the refrigerator.
 - Leave the door open to prevent mold developing within the refrigerator. If available, put the refrigerator door and the freezer door into the winter position.

Risk of injury

- Do not put your fingers into the hinge.
- Close and latch the refrigerator door before beginning a journey.
- The cooling system at the back of the refrigerator becomes very hot during operation. Protect yourself from coming into contact with hot parts when removing ventilation grilles.
- The device door or the freezer door can completely detach from the device if used incorrectly. Push the doors closed until you hear a clear click at the top and bottom.



NOTICE! Damage hazard

- Do not lean on the open refrigerator door.
- Store heavy objects such as bottles or cans only in the refrigerator door, in the vegetable compartment or on the bottom shelf.
- If the refrigerator has a double-sided door and the door is not locked correctly on the opposite side, push on that side at the top and the bottom until it locks in place.
- **Danger of overheating!**
Always ensure sufficient ventilation so that the heat generated during operation can dissipate. Ensure that the refrigerator is sufficiently far away from walls and other objects so that the air can circulate.
- Do not fill the interior with ice or fluid.
- Protect the refrigerator and the cable against heat and moisture.
- Never pull the plug out of the socket by the connection cable.



NOTE

- For ambient temperatures of +15 °C to +25 °C select the average temperature setting.
- If the door is not locked correctly on the opposite side, push on that side at the top and the bottom until it locks in place.

- **To avoid food waste, note the following:**
 - Keep temperature fluctuation as low as possible. Only open the refrigerator or the freezer as often and for as long as necessary. Opening the door for long periods can cause significant increase of the temperature in the compartments of the refrigerator.
 - Store the foodstuff in such a way that the air can still circulate well.
 - Ensure to put only items in the refrigerator which may be chilled at the selected temperature.
 - Store the different foodstuff types as shown in the figures.
 - If the temperature can be adjusted: Adjust the temperature to the quantity and type of the foodstuff.
 - Foodstuff can easily absorb or release odor or taste. Always store foodstuff covered or in closed containers/bottles.

4 Scope of delivery

Quantity	Description
1	Compressor refrigerator
1	Drain hose
1	Bottom trim piece
1	Sealing strip (fitted underneath during installation)
1	Installation and Operating Manual

5 Accessories

Available as accessories (not included in the scope of delivery):

Description	Ref. no.
LS300 ventilation grille	9620000524
Roof vent kit	9620008608, 9620008609
RUC5208X only: Door reversing kit	
• Left hand to right hand (LH to RH)	9620001938
• Right hand to left hand (RH to LH)	9600024323

Accessories are available from specialist dealers. If you have any questions, please contact the dealer or your service partner directly.

6 Intended use

The refrigerator is intended for:

- Installation in caravans, motor homes or on boats
- Cooling and storing food
- Storing prefrozen food

This refrigerator is **not** intended for commercial, retail or household applications.

The refrigerator is **not** suitable for:

- Storing medications

- Storing corrosive substances or substances that contain solvents
- Quick-freezing food.

The freezer compartment is suitable for storing pre-frozen food, storing or making ice cream and making ice cubes. It is not suitable for freezing previously unfrozen food.

The refrigerator is intended for installation in a piece of cabinetry or an installation niche.

This product is only suitable for the intended purpose and application in accordance with these instructions.

This manual provides information that is necessary for proper installation and/or operation of the product. Poor installation and/or improper operating or maintenance will result in unsatisfactory performance and a possible failure.

The manufacturer accepts no liability for any injury or damage to the product resulting from:

- Incorrect installation, assembly or connection, including excess voltage
- Incorrect maintenance or use of spare parts other than original spare parts provided by the manufacturer
- Alterations to the product without express permission from the manufacturer
- Use for purposes other than those described in this manual

Dometic reserves the right to change product appearance and product specifications.

7 Technical description

7.1 General

The refrigerator is a compressor refrigerator. The refrigerator is suitable for use with a 100 – 240 V AC voltage as well as with a 12 V or 24 V DC voltage.

The thermostatic control ensures that the refrigerator temperature is kept constant and as little power as possible is consumed.

The refrigerator withstands a short-term inclination of 30°, e.g. when used on boats.

The refrigerator is equipped with a cold weather/low temperature control that allows the refrigerator to operate at low ambient temperatures for extended periods of time.

All materials used in the refrigerator are compatible for use with foodstuffs. The refrigerant circuit is hermetically sealed.

7.2 Components

RUC5208X

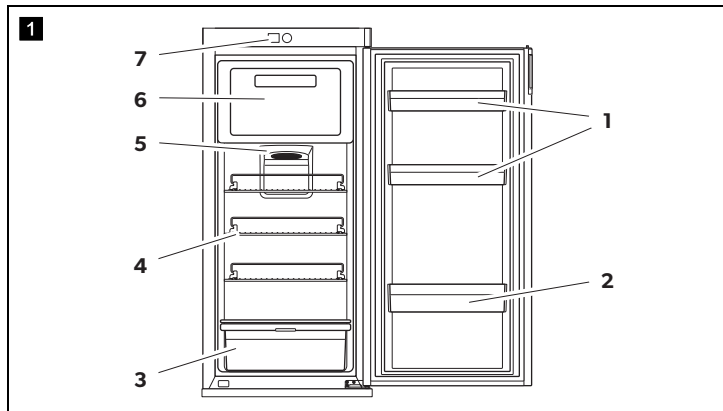

No. in fig. 1	Description	Quantity
1	Upper door rack	2
2	Bottom door rack with bottle holder	1
3	Crisper	1
4	Refrigerator shelf	3
5	Interior light	1
6	Freezer compartment	1
7	Control and display elements	1

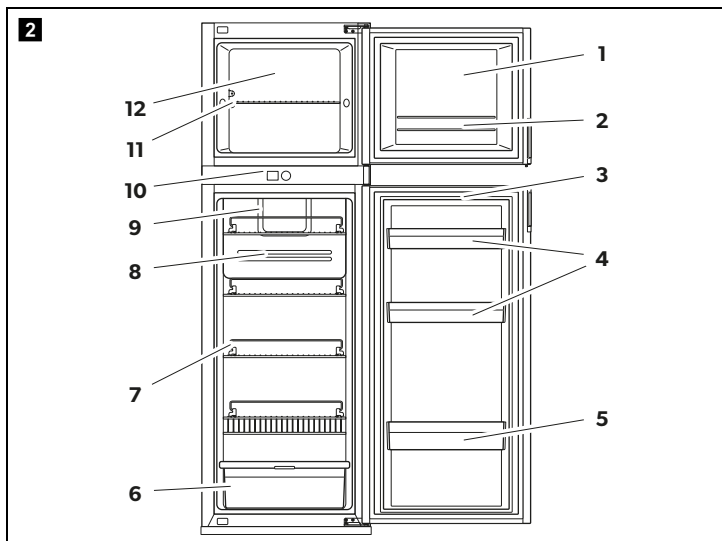
RUC6408X, RUC8408X

No. in fig. 2	Description	Quantity	
		RUC6408X	RUC8408X
1	Freezer compartment door	1	1
2	Freezer door rack	1	1
3	Refrigerator door	1	1
4	Upper door rack	2	2
5	Bottom door rack with bottle holder	1	1
6	Crisper	1	1
7	Refrigerator shelf	3	4
8	Air duct cover plate	1	1
9	Interior light	1	1
10	Control and display elements	1	1
11	Freezer shelf	1	1
12	Freezer compartment	1	1

7.3 Control and display elements

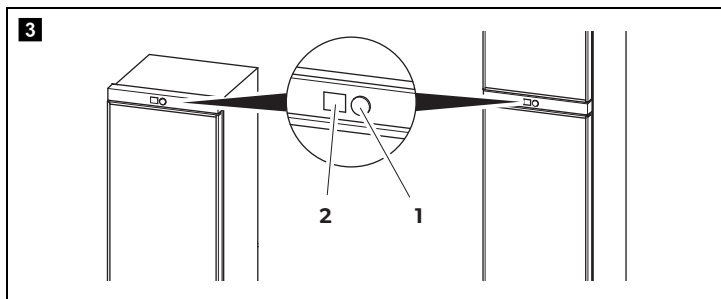

No. in
fig. **3**

Description

1 Control knob

2 Display

7.4 Control knob

Function of the control knob:

- Rotate: Choose menu item. The selected menu item is highlighted.
- Short press: Confirm
- Press for 2 – 4 seconds: Confirm a fault (chapter “Troubleshooting” on page 50)



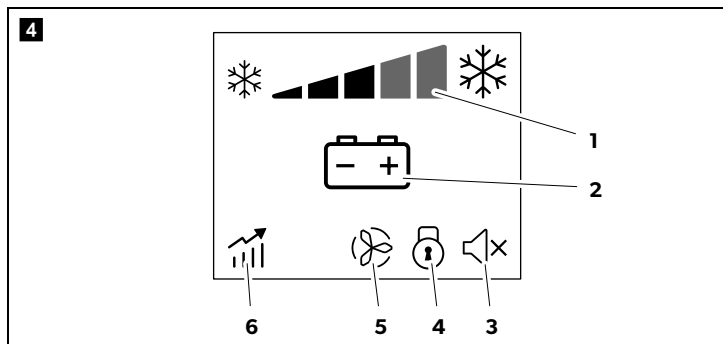

7.5 Display

Main menu

By default the display shows the following main menu:



No. in fig. 4	Symbol	Description
1		Cooling capacity indicator (cooling level 1 – 5) Blue snowflake: Compressor is on. White snowflake: Compressor is off.
2		Operation with AC power
		Operation with DC power
3		Beep off: Acoustic indication for extended door openings or fault messages is deactivated
		Beep on: Acoustic indication for extended door openings or fault messages is activated
4		Child lock activated (see chapter “Setting the child lock” on page 31)
5		Speed level of the outer fan:
		Low speed (1)
		High speed (2)

No. in fig. 4	Symbol	Description
6		User mode currently activated:
		PERFORMANCE mode (factory default): All functionalities of the refrigerator are activated. The inner fan switches on and off in the same way as the compressor. Cooling level 1 – 5
		SILENT mode: The outer fan operates at low speed. The inner fan switches on and off in the same way as the compressor. The compressor speed is limited. Cooling level 1 – 3
		ECO mode: Operation with reduced energy consumption. The inner fan remains switched on during the compressor switch-off cycles. The defrost function is switched off. Cooling level 3
		TURBO mode: The outer fan and the compressor operate at high speed. The inner fan switches on and off in the same way as the compressor. The defrost function is switched off. Cooling level 5







NOTE
TURBO mode:

When using TURBO mode, the refrigerator remains in this mode for 12 hours or until a temperature of -2°C is reached and then automatically switches to PERFORMANCE mode at cooling level 5.

Inner fan:

The inner fan switches off when the refrigerator door is opened.

User modes

	PERFORMANCE	SILENT	ECO	TURBO
Symbol				
Cooling level	1 – 5	1 – 3	3	5
Compressor speed	Auto	Limited	Auto	High
Outer fan	Auto	Low	Auto	High
Defrost function	Auto	Auto	Off	Off
Duration	Ongoing	Ongoing	Ongoing	max. 12 h

Settings menu

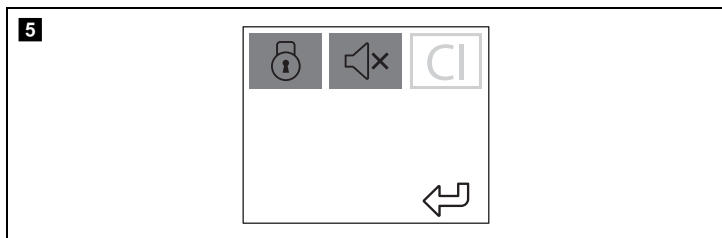

Button	Description
	Child lock
	Beep off
	CI-Bus (not applicable)

Standby mode and error screen

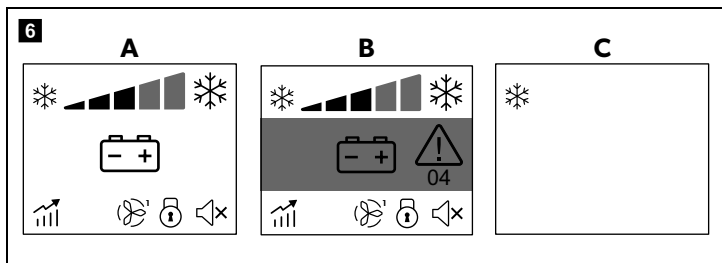

After 10 seconds without operating the control knob, the backlight dims and the display returns to the main menu (A). If activated, the child lock is active (see chapter “Setting the child lock” on page 31).

After 3 minutes without operating the control knob, the display switches to standby mode (C). A snowflake appears in the upper left corner to indicate that the refrigerator is on, even if the display is in standby mode.

**NOTE**

If there is an active error display, the display remains active without switching to standby mode. The display changes to the error screen (B). In the error screen, the middle section is highlighted in red and shows the corresponding error code (see chapter “Troubleshooting” on page 50).

8 Installation



CAUTION! Risk of injury

The refrigerator has sharp edges. Use gloves during installation.



NOTICE! Damage hazard

Do not install the refrigerator in the rear of motor homes with the door facing the direction of travel.

8.1 Preparing the installation

When installing the refrigerator, note the following:

- Ensure that the floor is solid and level.
Park the vehicle horizontally for this purpose.
- The refrigerator must be installed so that:
 - The refrigerator is easily accessible for service work.
 - The refrigerator is easy to uninstall and install.
 - The refrigerator can be easily removed from the vehicle.
- The refrigerator must be installed in a recess so that it stands secure when the vehicle is in motion. Note the dimensions in fig. 8.
- The refrigerator must be installed with a minimum distance of 5 mm from the floor to ensure that the door can be opened properly (fig. 7).
 - Ensure that no carpets interfere with the free movement of the door.
 - Avoid placing the refrigerator directly on the floor.
- The refrigerator must not be installed to the side of the air inlet and outlet vents as this leads to poor performance and increases the power consumption of the refrigerator.
- The air inlet and outlet vents must not be covered by vehicle parts during operation (e.g. by an open door or by attached accessories such as bicycle racks).
- Choose a location where the refrigerator is protected from drafts, excessive heat and moisture.

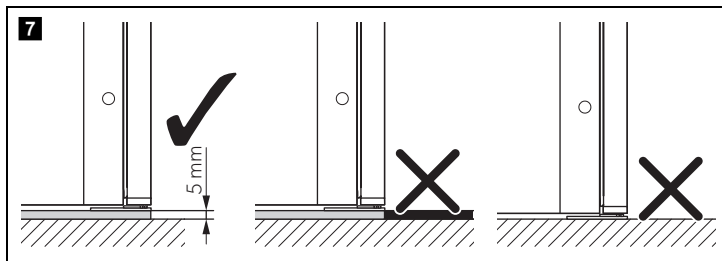

8

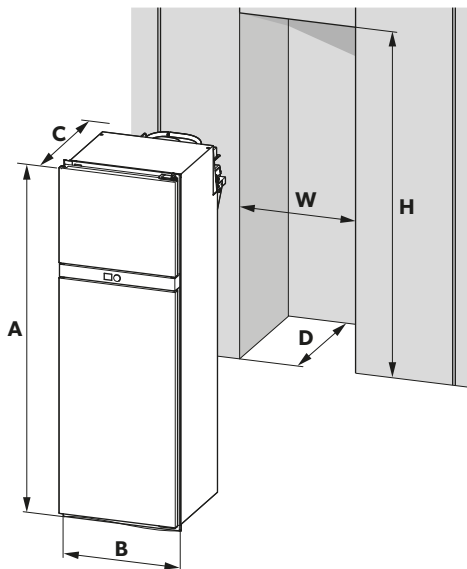

	RUC 5208X	RUC 6408X	RUC 8408X
Refrigerator			
Dimension in mm			
Height (A)	1191	1657	1447
Width (B)	550	550	550
Depth (C) (excluding control knob, 5 mm)	677	677	677
Recess			
Height (H)	1181 – 1186	1437 – 1442	1647 – 1652
Width (W)	530 – 535	530 – 535	530 – 535
Depth (D)	min. 611	min. 611	min. 611

8.2 Installing the refrigerator

The distance between the refrigerator and the back wall has an impact on the cooling performance and power consumption. For optimal cooling performance:

- Ensure that the clearance between the refrigerator and the rear wall is at least 10 mm and not more than 25 mm.
- If a clearance of >25 mm cannot be avoided: Install an air guide, e.g. a ventilation plate, to reduce the air duct to a maximum width of 25 mm.

Air inlet vents and air outlet vents (**3a** and **3b**) must be installed in the outer wall so that the air can circulate and the heat generated can be dissipated to the outside.

- Select one of the following installation variants depending on the installation situation:
 - Installation with two rear vents (fig. **9**, page 17)
 - Installation with one lower rear vent and one roof vent (fig. **10**, page 19)

Installation with two rear vents

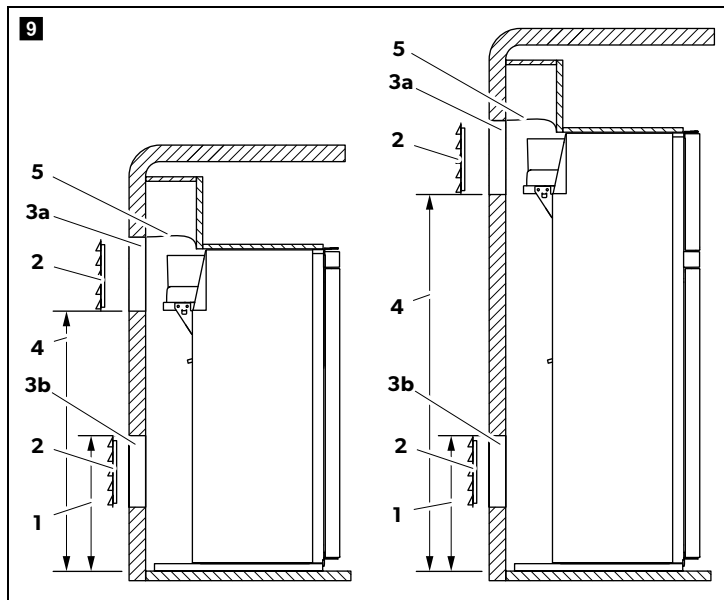

No. in fig. 9	Description
1	Maximum height for the top edge of the ventilation grille (250 mm below the compressor shelf)
2	LS 300 ventilation grille (accessories)
3a	Air outlet vent
3b	Air inlet vent
4	Minimum height for the bottom edge of the ventilation grille (equal to the height of the compressor shelf)
5	Air baffle

- Install an air baffle (fig. 9 5) above the compressor unit to prevent the heat from accumulating in the vehicle.
 - Make cut outs in the wall for the air inlet and outlet vents. Observe the required dimensions specified in the installation manual for the LS ventilation grille.
 - **Position of the air inlet vent:** It must be possible to install the ventilation grille so that the lower edge of the ventilation grille is at least 250 mm from the compressor shelf (fig. 9 1).
 - **Position of the air outlet vent (rear venting):** It must be possible to install the ventilation grille so that the bottom edge of the ventilation grille is not below the compressor shelf.
- Note:** Ensure that the bottom edge of the ventilation grille is as close as possible to the compressor shelf for optimum service access.

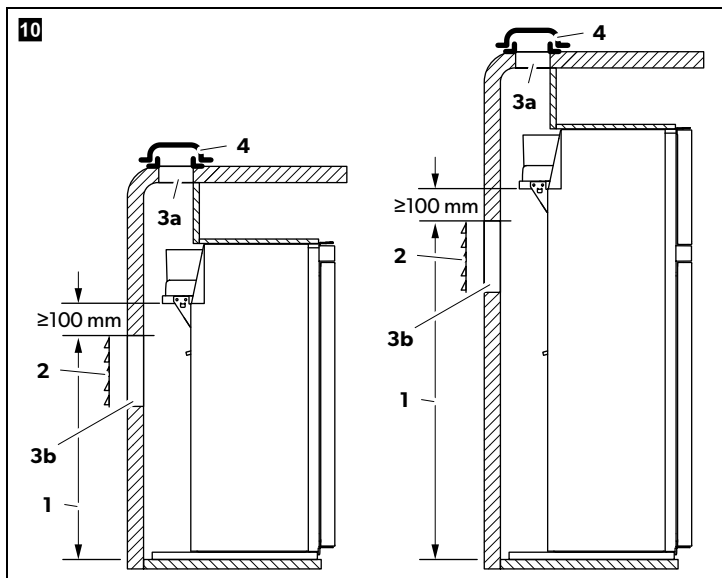
Installation with one lower rear vent and one roof vent**No. in
fig. 10****Description**

- | | |
|----|---|
| 1 | Maximum height for the top edge of the ventilation grille
(equal to 100 mm below the compressor shelf) |
| 2 | LS300 ventilation grille |
| 3a | Air outlet vent |
| 3b | Air inlet vent |
| 4 | Roof vent |

- Make cut outs in the wall for the air inlet and outlet vents. Observe the required dimensions specified in the installation manual for the LS ventilation grille and the roof vent kit.
- **Position of the air inlet vent:** It must be possible to install the ventilation grille so that the lower edge of the ventilation grille is at least 100 mm from the compressor shelf (fig. 10 1).
 - **Position of the air outlet vent (roof venting):** The air outlet vent must be located directly above the cooling unit at the rear of the refrigerator.
- Note:** If the air outlet vent **cannot** be installed directly, but only offset above the back of the refrigerator: Install an air duct to prevent the heat from accumulating.

8.3 Installing the ventilation grille



NOTE

Use the LS300 ventilation grille (accessories).

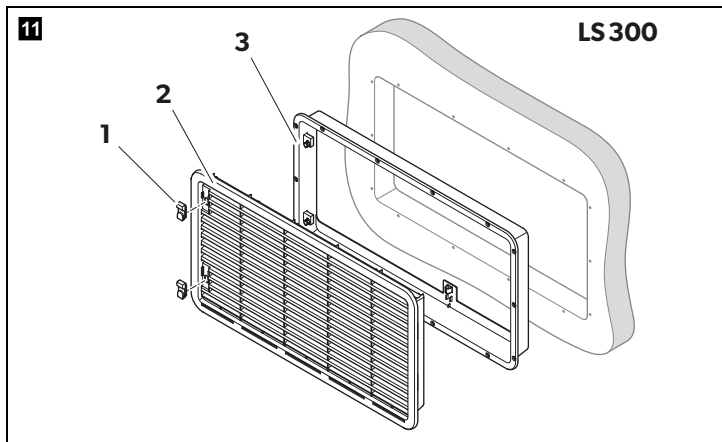

No. in fig. 11

Description

1	Slider
2	Grille
3	Mounting frame

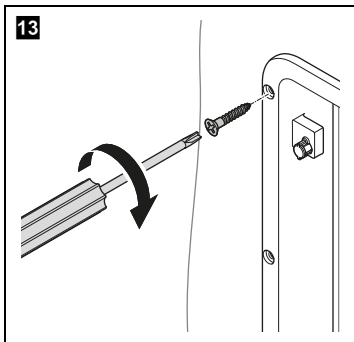
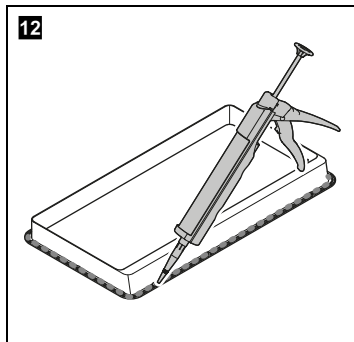

1. Apply sealant to the inner edge of the mounting frame to ensure the installation is water resistant (fig. 12).
2. Insert the mounting frame into the prepared openings in the outer wall (see chapter "Installing the refrigerator" on page 17) and screw the mounting frame to the mounting holes (fig. 13).

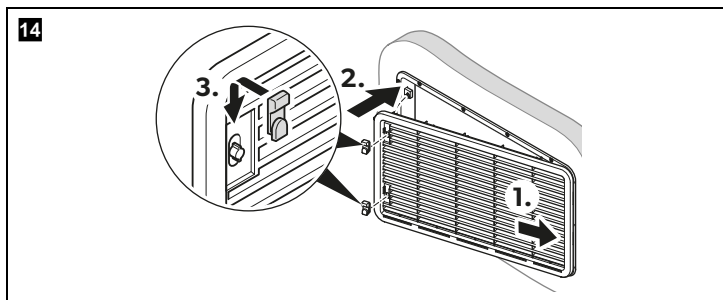

3. Insert the grille (fig. 14 1 and 2).
4. Insert the slider to lock the grille in place (fig. 14 3).

8.4 Installing the roof vent



NOTE

Use the roof vent kit (accessories).

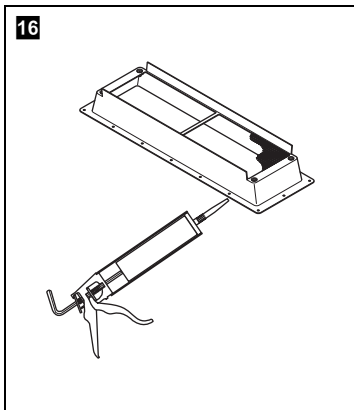
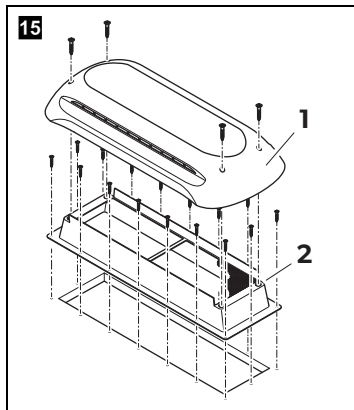

No. in fig. 15 Description

- | | |
|---|----------------|
| 1 | Hood |
| 2 | Mounting frame |

1. Apply sealant to the inner edge of the mounting frame to ensure the installation is water resistant (fig. 16).

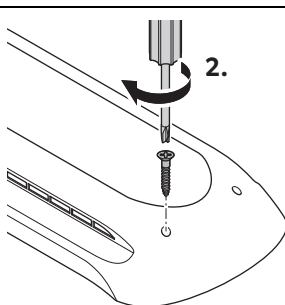
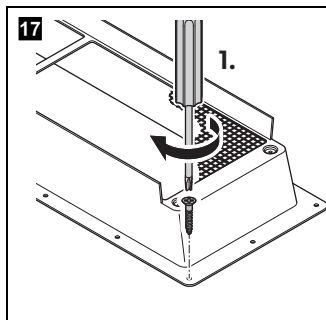

2. Insert the mounting frame into the prepared opening in the outer wall (see chapter "Installing the refrigerator" on page 17) and screw the mounting frame to the mounting holes (fig. 17 1).
3. Insert the hood and screw it tight (fig. 17 2).

8.5 Installing the drain water hose



NOTICE! Damage hazard

- Position the opening for the drain hose so that the drain hose does not touch the boiler housing to avoid damage to the drain hose.
- Avoid kinking of the drain water hose.

1. Drill a hole through the floor at the rear of the refrigerator (Ø 18 mm).
2. Route the drain water hose through the drilled hole and align the hose so that it can direct the water out of the vehicle.
3. Seal the drilling hole around the drain water hose.

8.6 Sealing the refrigerator

Refrigerators in caravans or motor homes must be installed in an enclosed space so that dust and heat cannot enter the living space directly.

For this purpose, a suitable seal must be installed between the rear wall of the refrigerator and the interior of the vehicle in order to seal the interior of the vehicle from the cooling unit and ventilation area of the refrigerator.



WARNING! Fire hazard

Do not use flammable materials for the draught-proof installation.

Sealing the refrigerator using the sealing strip

The manufacturer has applied a sealing strip to the rear surface of the front frame.

18

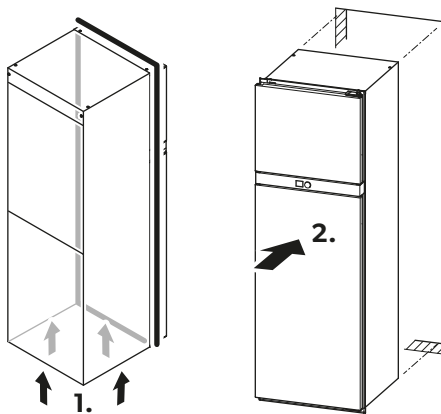

1. Apply the sealing strip to all four sides of the bottom surface of the refrigerator (fig. **18 1**).
 2. Push the refrigerator into position (fig. **18 2**).
- ✓ The space behind the refrigerator is sealed to the interior of the vehicle.

Sealing the refrigerator using the bottom trim

If the refrigerator is placed on a platform, the bottom trim must be installed to seal the space between the refrigerator and the platform.

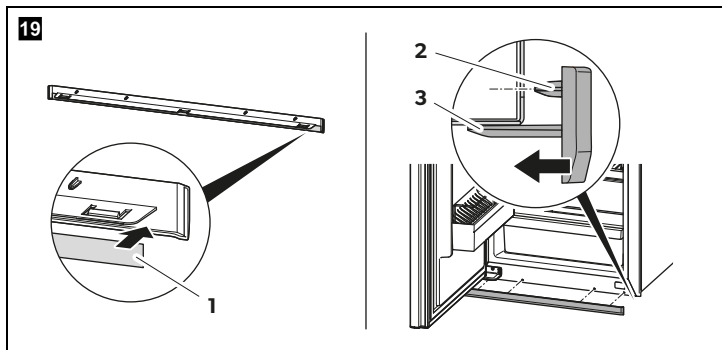

1. Apply a sealing strip (fig. **19 1**) to the lower surface of the bottom trim piece.
2. Push the bottom trim with the four plugs (fig. **19 2**) into the holes on the bottom frame of the refrigerator.
3. Snap the three catches (fig. **19 3**) into the holes under the bottom frame of the refrigerator.

8.7 Securing the refrigerator



CAUTION! Electrocuting hazard and damage hazard

- Only screw through the holes provided on the refrigerator for fastening to prevent injury from damaged electrical cables or damage to foamed components.
- Ensure to tighten the screws firmly so that they do not loosen under increased load (e.g., while driving).

1. Slide the refrigerator into its final place.
2. Align the refrigerator so that
 - The front flange is flush with the front edge of the recess.
 - The refrigerator is standing level.

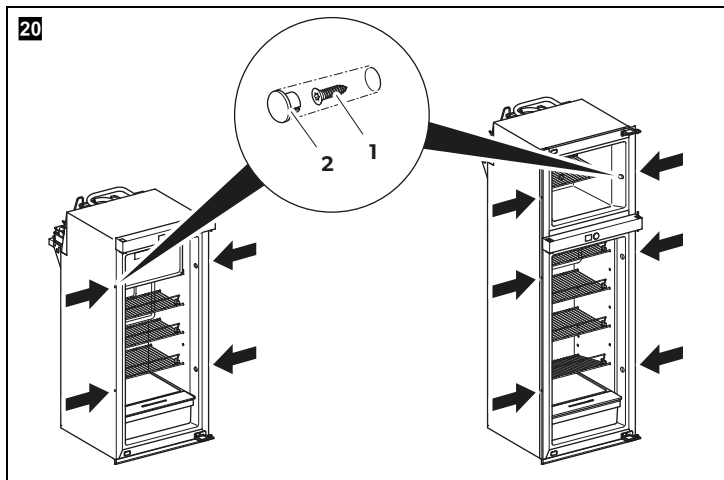

3. Insert the screws (fig. **20 1**) through the plastic bushings on the sides of the refrigerator and screw the refrigerator into the recess.
4. Fit the caps (fig. **20 2**) onto the bushings.

9 Connecting the refrigerator



NOTICE! Damage hazard

Lay the connection cables so that they do not come into contact with hot parts of the device or with sharp edges.

9.1 Connecting the refrigerator to DC power supply



The electrical power supply must be connected by a qualified electrician who has demonstrated skill and knowledge related to the construction and operation of electrical equipment and installations, and who is familiar with the applicable regulations of the country in which the equipment is to be installed and/or used, and has received safety training to identify and avoid the hazards involved.



WARNING! Electrocution hazard

Observe the recommended cable cross-sections, cable lengths and fuses.



CAUTION! Fire hazard

Place the fuse near the starting battery to protect the cable from short circuits and possible burning.



NOTICE! Damage hazard

- Do not reverse the polarity.
- To avoid voltage drops and power losses, keep the connection cable uninterrupted and as short as possible. Do not install additional switches, plugs or socket strips.

1. Determine the required cross section of the cable in relation to the cable length (fig. 21).

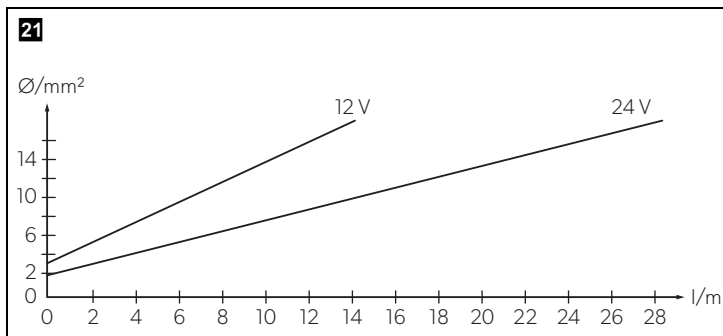

2. Connect the supply cable to the refrigerator DC terminal block (fig. 22 1).

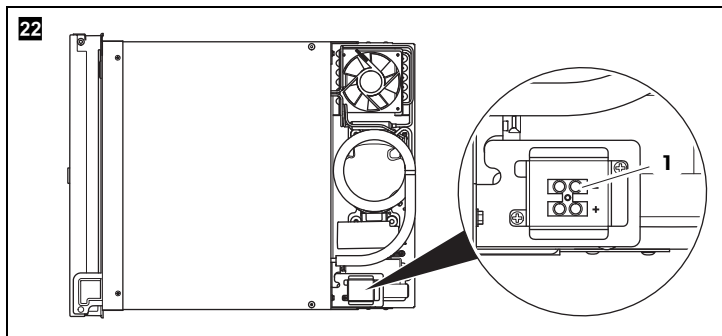

3. Protect the positive cable of the vehicle battery with a fuse:

- 12 V: 15 A
- 24 V: 7.5 A

9.2 Connecting the refrigerator to AC power supply



DANGER! Electrocuting hazard

- Never handle plugs and switches with wet hands or when standing on a wet surface.
- If the refrigerator is operated on a boat with an AC mains connection via a shore connection, a residual current circuit breaker must be installed between the AC mains and the refrigerator. Seek advice from a qualified technician.
- The refrigerator must be controlled by a two-pole switch that is suitable for the intended purpose. Ensure that the two-pole switch is installed and marked in such a way that it is easily recognizable for use.

► Connect the refrigerator with the mains plug to an AC socket.

10 Using the refrigerator

10.1 Before first use



NOTE

- Do not store goods in the refrigerator for the first 4 hours after start-up.
- When using the refrigerator for the first time, there may be a mild odor which will disappear after a few hours. Air out the living space well.
- Always park the vehicle so that it is level, especially when starting up and filling the refrigerator before setting off on a journey.

► Clean the inside of the refrigerator for hygienic reasons (see chapter "Cleaning and maintenance" on page 48).

10.2 Information on storing food



CAUTION! Health hazard

If the refrigerator is exposed to an ambient temperature below +10 °C for an extended period of time, regulation of the frozen compartment temperature can no longer be guaranteed. That may cause the temperature of the frozen compartment to increase and the stored goods to be defrosted.



NOTICE! Damage hazard

- Observe the maximum load per door shelf and door when filling the refrigerator (see chapter "Technical data" on page 55).
- Do not keep carbonated drinks in the frozen compartment.

► Store food as shown in fig. 23:

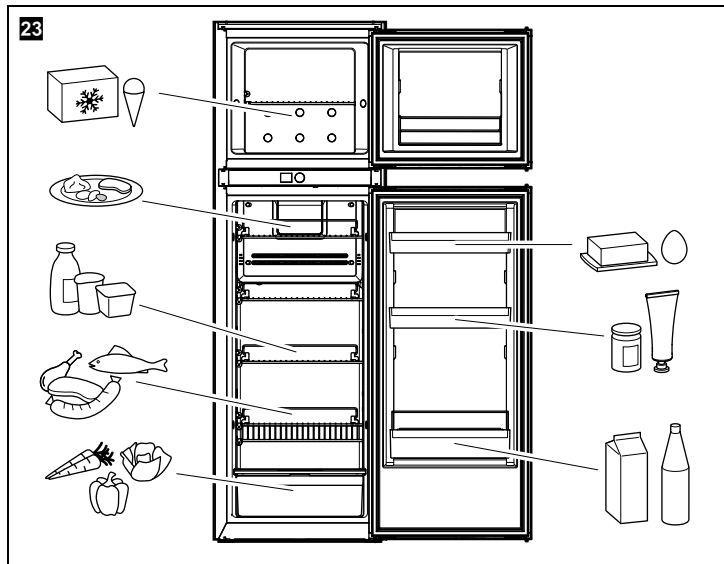

10.3 Saving energy

- Only open the refrigerator as often and for as long as necessary.
- Allow warm food to cool down first before placing it in the device to keep cool.
- Defrost your refrigerator as soon as a layer of ice forms.
- Avoid unnecessarily low temperature settings.

- For optimal energy consumption, position the shelves and drawers according to their position on delivery.
- On a regularly basis, make sure the door seal still fits properly.
- Clean dust and dirt from the condenser at regular intervals.
- Arrange the food in the refrigerator so that air can circulate.

10.4 Tips for optimal refrigerator operation

- Protect the interior of the vehicle from warming up excessively (e.g. sunshades in the windows, air conditioner).
- Protect the refrigerator from direct sunlight (e.g. sunshades in the windows).

10.5 Switching on the refrigerator

- Press and hold the control knob for at least 3 seconds.
- ✓ The refrigerator starts with the last selected power source.

10.6 Switching off the refrigerator



- Press and hold the control knob for at least 3 seconds.
- ✓ The refrigerator switches off.

10.7 Operating the refrigerator

Menu navigation: fig. 24

- Press the control knob to activate the display.

The main menu is divided into two submenus:

Main menu	Submenu
	Cooling capacity
	Settings

24

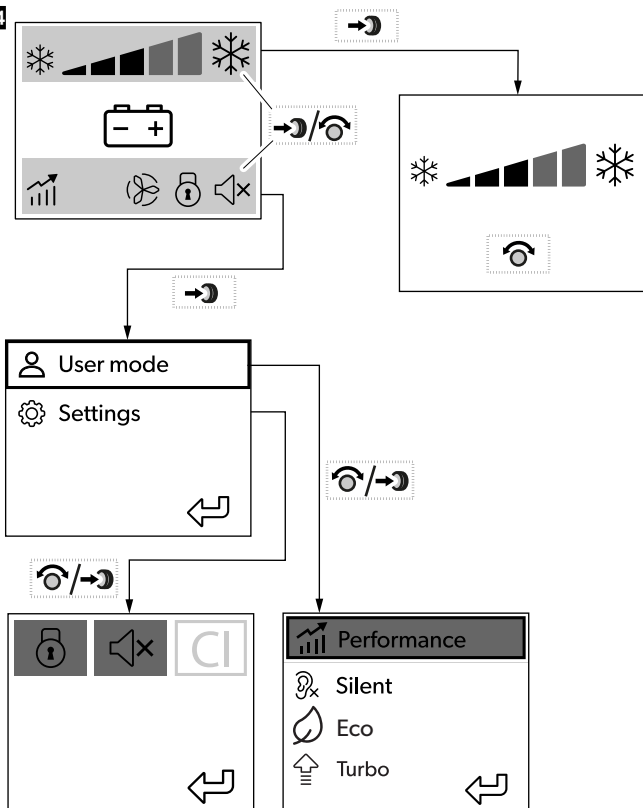

1. Rotate the control knob to select a submenu.
2. Press the control knob to open the selected submenu.
✓ The submenu opens.
3. Rotate the control knob to navigate through the submenu items or to adjust a setting.
4. Press the control knob to select a submenu item and confirm a setting.
5. Press to return to the main menu.

10.8 Setting the cooling capacity



NOTE

For ambient temperatures of +15 °C to +25 °C, select the average cooling capacity.

1. Select the submenu "Cooling capacity" (see table on page 29).
2. Rotate the control knob to set the desired cooling level.

10.9 Setting the child lock

The child lock can be activated to prevent children from using the controls.

1. Select the submenu "Settings" (see table on page 29) and open "Settings".
2. Push the  button to activate or deactivate the child lock.
 - ✓ The symbol is shown on the main menu.
 - ✓ After 10 seconds without operating the control knob, the backlight dims and the child lock is active.

Operating the display with the child lock activated

The child lock can be temporarily deactivated to operate the display. The child lock is automatically reactivated as soon as the display dims (no operation of the control knob within 10 seconds).

- Press the control button 3 times within 1.5 seconds to deactivate the child lock temporarily.

10.10 Using the refrigerator door/freezer compartment door



CAUTION! Risk of injury

- Ensure that the refrigerator door and the freezer compartment door are locked before setting off on a journey.
- Always open the doors carefully, as the foodstuff may have slipped and could fall out.



NOTICE! Damage hazard

Do not open the refrigerator door and freezer compartment door further than a 90° angle to avoid damaging the doors.

Opening the refrigerator door/freezer compartment door

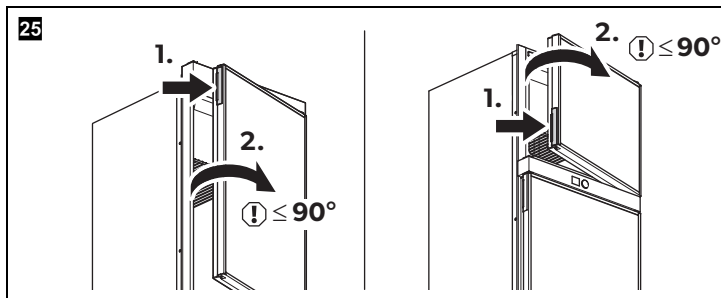

- Press the handle and pull the door open.

Locking the refrigerator door/freezer compartment door

1. Ensure the door is not in the winter position (chapter "Positioning the refrigerator door/freezer compartment door into winter position" on page 32).
 2. Press the door shut until it clearly audibly clicks into place.
- ✓ The door is now closed and secured.

Positioning the refrigerator door/freezer compartment door into winter position



CAUTION! Risk of injury

The winter position may **not** be used while driving.

Put the refrigerator door and the freezer compartment door into the winter position if the refrigerator will not be used for an extended period of time. This prevents mold from forming.

1. Defrost the refrigerator (chapter "Defrosting the refrigerator" on page 49).
 2. Turn the locking latch 180° (fig. 26 3.).
- ✓ The door is locked in position.

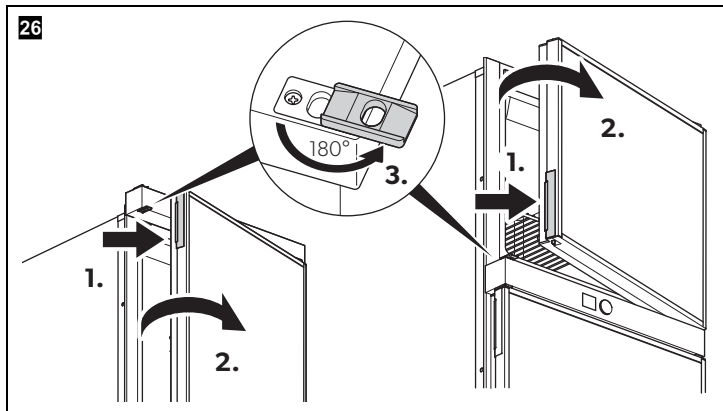





10.11 Using the crisper



NOTICE! Damage hazard

The maximum load capacity of the crisper is 18 l.

- Use the slider in the crisper (fig. 27, page 33) to regulate the humidity in the vegetable compartment:

Goods to be cooled		Optimal humidity		Slider position
Vegetables		High		► Close the slider.
Fruit		Low		► Open the slider.

27

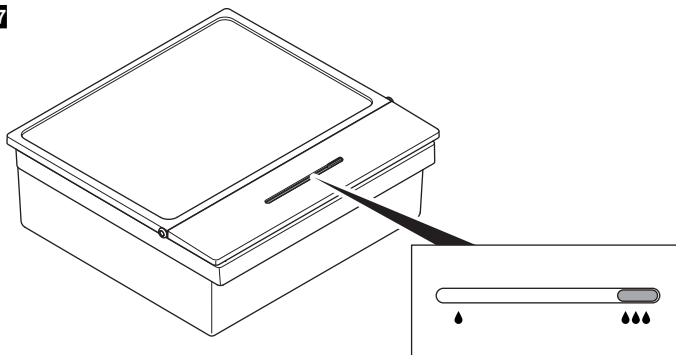

10.12 Removing and refitting the shelves



WARNING! Risk of child entrapment

All shelves are fixed in place to prevent children from climbing inside the refrigerator.

- Only remove the shelves for cleaning purposes.
- Refit the shelves and secure them in place.

Removing the shelves (fig. 28)

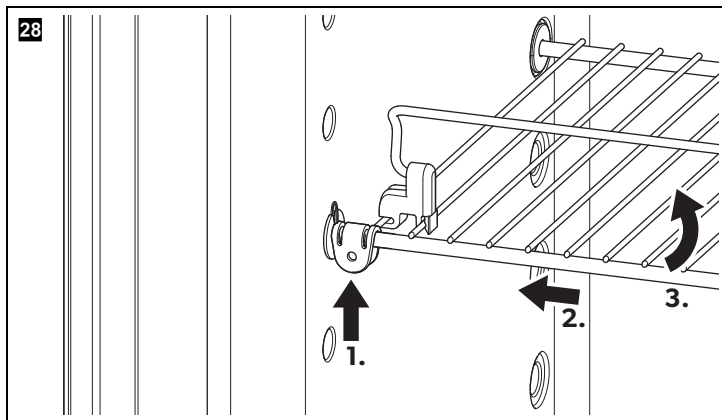

1. Push the locking clamps upwards and remove them (1.).
2. Slide the shelf to the left until the plastic holders on the right side are free (2.).
3. Tilt the right end of the shelf up until the plastic holders on the left side are free (3.).
4. Pull the shelf out frontwards.

Refitting the shelves

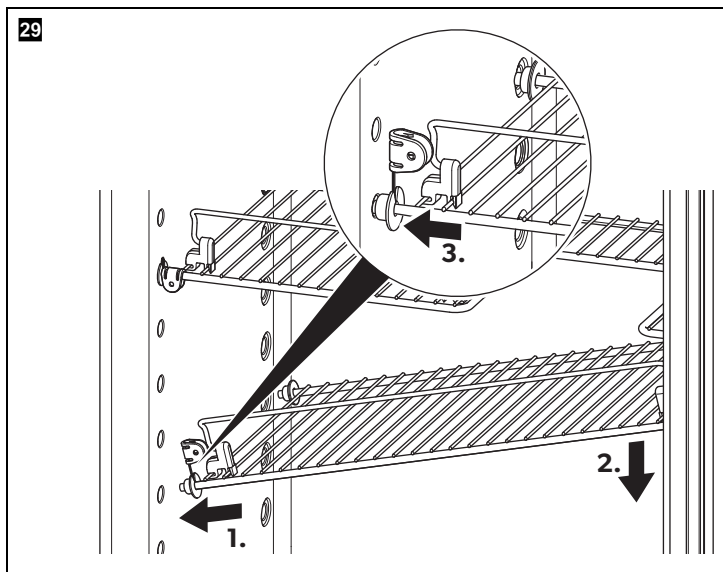

1. Tilt the right end of the shelf up to slide the shelf back into the refrigerator compartment.
2. Position the plastic holders on the left side in the suspension (fig. **29 1.**).
3. Tilt the right end of the shelf down to align it level and slide the plastic holders on the right side into the suspension. (fig. **29 2.**).
4. Ensure that the plastic holders are firmly seated in the suspensions (fig. **29 3.**).
5. Reattach the locking clamps (fig. **30**).

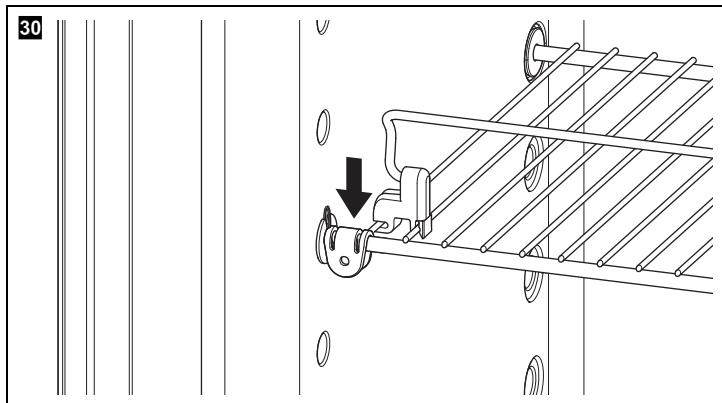

Positioning the bottle shelf

The shelves can be optionally installed in a backward or forward sloping position as a bottle rack.

► Remove the respective shelf and relocate the shelf as shown in fig. 31.

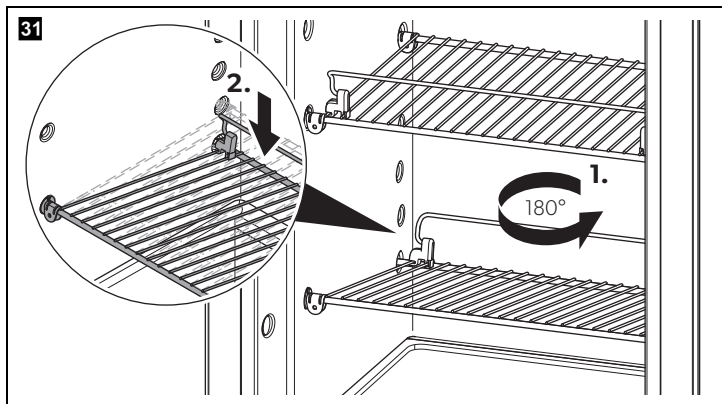

10.13 Replacing the door panel

Removing the door panel

- Pull off the decorative strip at the upper edge of the door and slide the door panel out of the door frame (fig. 32).

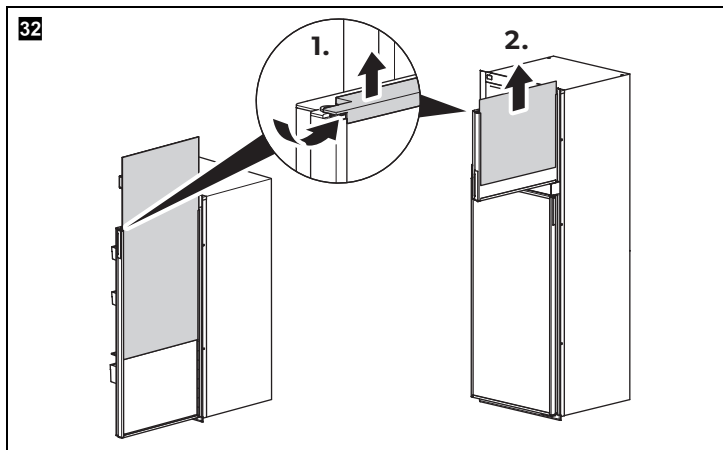

Installing the door panel

- Slide the door panel into the door frame and attach the decorative strip to the upper edge of the door (fig. 33).

**NOTE**

When sliding the panel into the door frame, ensure that the edges fit into the grooves of the door frame.

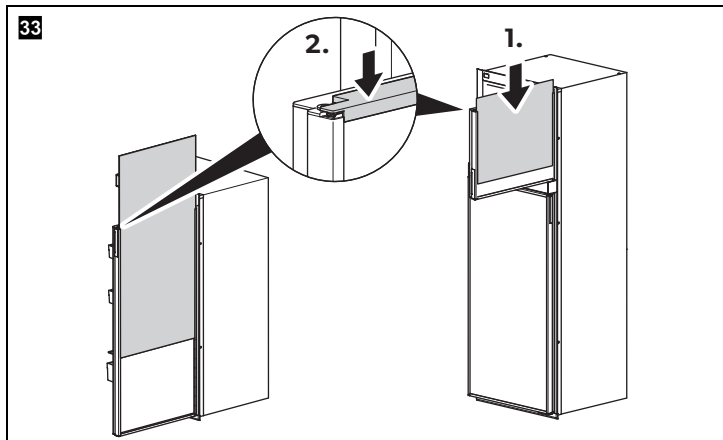
**10.14 Reversing the door stop (RUC 5208X only)****NOTICE! Damage hazard**

Be careful not to damage the door bushing and the surface of the door panel.

**NOTE**

Use the required **door reversing kit** (accessories).

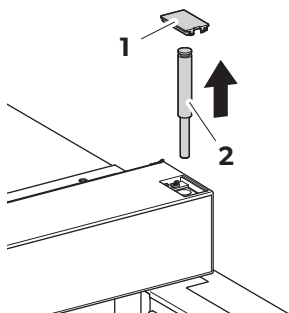
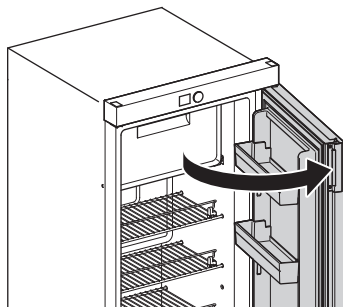
34 RUC 5208X

1. Open the door.
2. Remove the cover of the top hinge pin (fig. 34 1) using a small screwdriver.
3. Pull out the top hinge pin (fig. 34 2) using pliers.

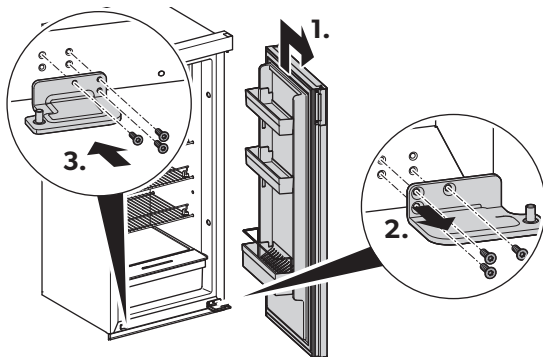
35 RUC 5208X

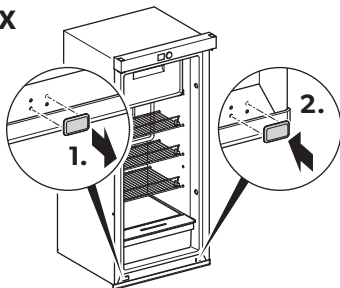
36 RUC 5208X

4. Remove the refrigerator door by lifting the refrigerator door over the bottom hinge pin (fig. **35 1.**).
5. Place the refrigerator door level on a soft material to avoid scratches.
6. Unscrew and discard the bottom hinge (fig. **35 2.**).
7. Remove the cover from the screw holes (fig. **36 1.**).
8. Attach the cover to the screw holes on the opposite side (fig. **36 2.**).
9. Screw the new bottom hinge (accessory) to the new position on the opposite side of the door frame (fig. **35 3.**).

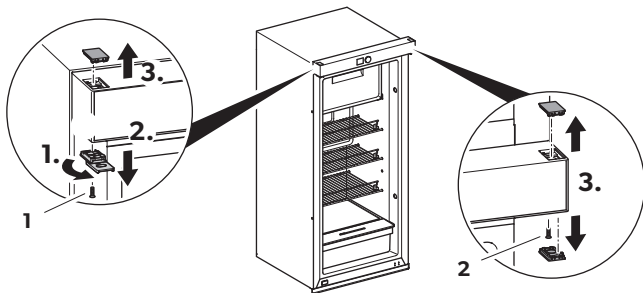
37 RUC 5208X

10. Turn the locking latch 180° (fig. **37 1.**).
11. Loosen the screw at the locking latch (fig. **37 1**) and remove the locking latch (fig. **37 2.**).
12. Remove all covers and the bushing using a small screwdriver (fig. **37 3.**).
13. Remove the screw located under the bushing at the hinge side (fig. **37 2**).

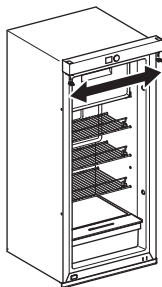
38 RUC 5208X

14. Attach the locking latch and bushing to the opposite side of the door frame from their respective starting position (fig. **38**).

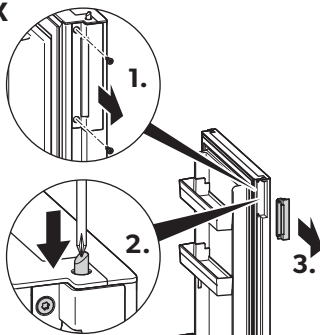
39 RUC 5208X

15. Remove the two screws (fig. **39 1.**) from the latch assembly.
 16. Use a small screwdriver to push the spring bolt inwards and release the latch assembly (fig. **39 2.**).
 17. Remove and discard the latch assembly (fig. **39 3.**).
 18. Remove the latch blank at the opposite side of the door.
 19. Push the spring bolt at the opposite side of the door inwards to insert the new latch assembly (accessories).
 20. Install the new latch assembly and the latch blank to the opposite side of the door frame from their respective starting position.

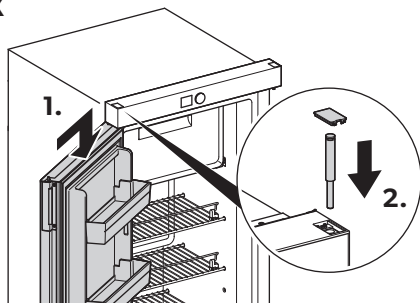
40 RUC 5208X

21. Insert the refrigerator door onto the bottom hinge pin at the new position on the opposite side of the door frame (fig. **41** 1.).

22. Push the top hinge pin into the refrigerator door top bush and attach the top pin cover (fig. **41** 2.).

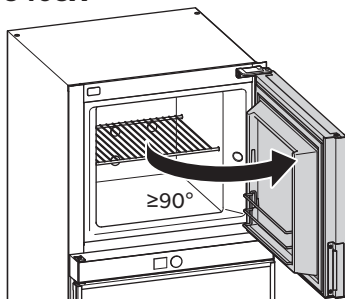
10.15 Reversing the door stop (RUC 6408X, 8408X only)**41 RUC 6408X, 8408X**

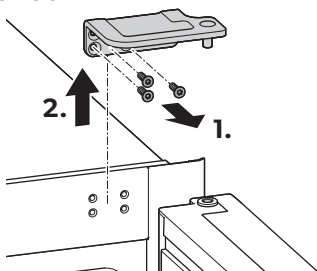
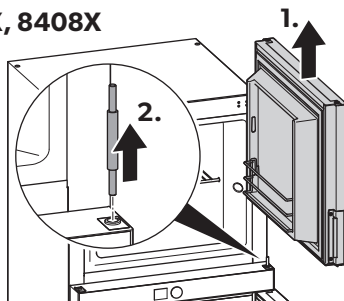
42 RUC 6408X, 8408X**43 RUC 6408X, 8408X****NOTICE! Damage hazard**

Be careful not to damage the door bushing and the surface of the door panel.

1. Open the freezer door more than 90°.
2. Remove the three screws (fig. 42 1.) from the upper hinge.
3. Pull the top hinge upwards out of the bushing and away from the freezer door (fig. 42 2.).
4. Remove the freezer door by lifting the freezer door over the middle hinge pin (fig. 43 1.).
5. Place the freezer door level on a soft material to avoid scratches.
6. Hold the refrigerator door so that it cannot fall off and pull out the middle hinge pin (fig. 43 2.).

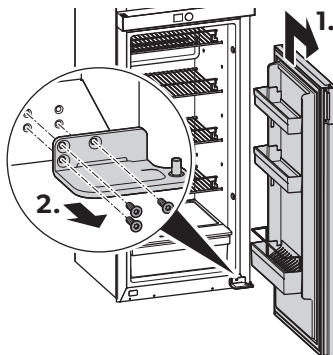
44 RUC 6408X, 8408X

7. Remove the refrigerator door by lifting the refrigerator door over the bottom hinge pin (fig. **44 1.**).
8. Place the refrigerator door level on a soft material to avoid scratches.
9. Remove the three screws from the bottom hinge (fig. **44 2.**).

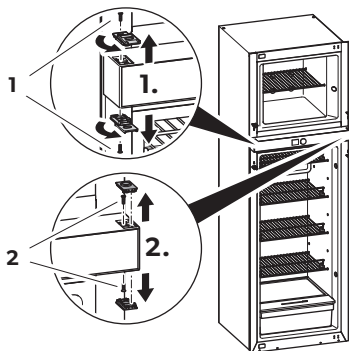
45 RUC 6408X, 8408X

10. Turn the locking latches on the latch side by 180° to expose the screws.
11. Remove the screws at the locking latch (fig. **45 1.**).
12. Remove the locking latches (fig. **45 1.**).
13. Remove the hinge bushings on the hinge side using a small screwdriver (fig. **45 2.**).

14. Remove the screws under the hinge bushings on the hinge side (fig. 45 2).

46 RUC 6408X, 8408X

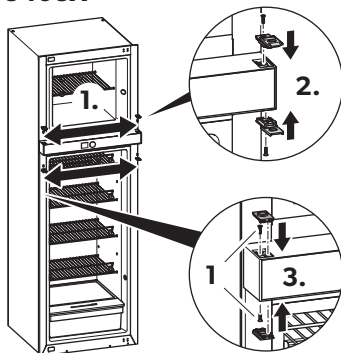

15. Attach the locking latches and the bushings to the opposite side of the door frame from their respective starting position (fig. 46).



NOTE

- The screws under the hinge bushings on the opposite side remain and are not exchanged (fig. 46 1).
- When installing the latch assemblies, push and keep the latch spring bolt fully in.

47 RUC 6408X, 8408X

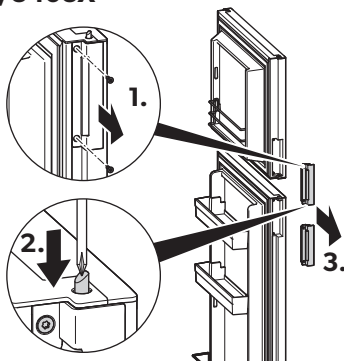

16. Remove the two screws (fig. 47 1.) from the latch assemblies on the freezer door and on the refrigerator door.
17. Use a small screwdriver to push the spring bolt inwards and release the latch assembly (fig. 47 2.).
18. Remove the latch assemblies (fig. 47 3.).
19. Remove the latch blanks at the opposite side of both doors.
20. Attach the hinge bushings to the opposite side.
21. Install the latch assemblies and the latch blanks to the opposite side of the door frame from their respective starting position.

48 RUC 6408X, 8408X

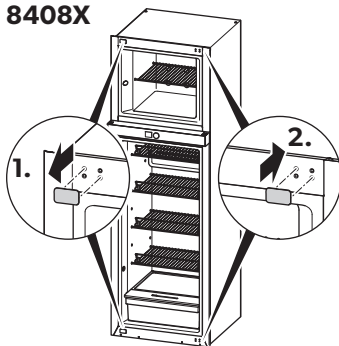

22. Remove the covers from the screw holes at the top and bottom hinge points using a small screwdriver (fig. 48 1.).
23. Attach the covers to the screw holes on the opposite side (fig. 48 2.).
24. Turn the former top hinge 180° and mount the hinge to the bottom hinge position using the three screws.
25. Insert the refrigerator door onto the bottom hinge pin at the new position on the opposite side of the door frame.

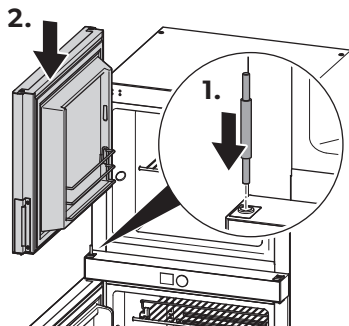
49 RUC 6408X, 8408X

26. Insert the middle hinge pin and push it into the top of the refrigerator door (fig. **49 1.**).

✓ The refrigerator door is now fixed.

27. Insert the freezer door onto the middle hinge pin (fig. **49 2.**).

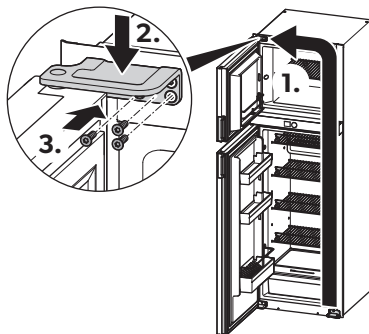
50 RUC 6408X, 8408X

28. Open the freezer door more than 90°.

29. Turn the former bottom hinge 180°, insert the hinge pin into the freezer door and mount the hinge to the top hinge position using the three screws (fig. **50**).

✓ The freezer door is now fixed.

11 Cleaning and maintenance

**WARNING! Electrocutation hazard**

Always disconnect the refrigerator from the AC and DC power supply before cleaning.

**NOTICE! Damage hazard**

- Do not use abrasive cleaning agents or hard objects during cleaning as these can damage the refrigerator.
- Never use hard or sharp tools to remove ice or to free objects frozen onto the device.
- Do not use any mechanical tools or any other tools to speed up the defrosting process.

- Clean the refrigerator regularly and as soon as it becomes dirty with a damp cloth.
- Ensure that no water drips into the seals or the controls as this can damage the electronics.
- Wipe the refrigerator dry with a cloth after cleaning.
- Check the condensate drain regularly.

Clean the condensate drain when necessary. If it is blocked the condensate collects on the bottom of the refrigerator.

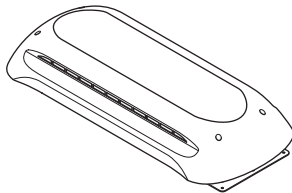
51

- Ensure that the ventilation grilles in the outer wall of the recreational vehicle and the roof vent of the refrigerator (fig. 51) are free of any dust and dirt, so that heat generated during operation can dissipate.

11.1 Defrosting the refrigerator

The refrigerator compartment is equipped with an automatic cyclic defrost system that prevents excessive frost formation on the evaporator fins. If the refrigerator is used for a long time in high humidity and/or high ambient temperatures, frost may still form on the evaporator fins and the refrigerator must be defrosted manually.



NOTICE! Damage hazard

Do not use mechanical tools or a hair dryer to remove ice or to loosen frozen items.



NOTE

The freezer compartment must be defrosted at regular intervals. Defrost the freezer compartment once the frost layer is higher than 3 mm.

52

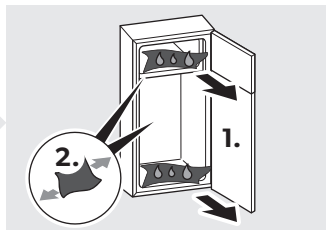
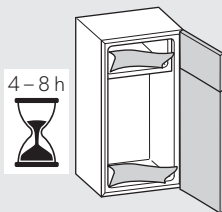
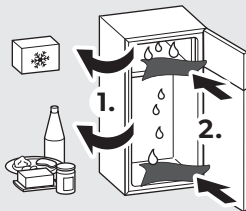
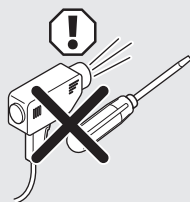

1. Disconnect the power supply.
2. Remove the contents from the freezer and refrigerator compartments.
3. Put a cloth in the freezer and refrigerator compartment to absorb any excess water.
4. Leave the doors open for at least 4 h.
- ✓ The condensate drains off through a hose at the back of the refrigerator and is discharged to the outside of the vehicle.
5. Wipe the freezer and refrigerator compartment dry with a cloth.

12 Troubleshooting

Problem	Possible cause	Suggested remedy
Poor cooling performance. The refrigerator does not reach the set cooling temperature or exceeds the set cooling temperature.	The ventilation around the cooling unit is not sufficient.	<ul style="list-style-type: none"> ► Check that no ventilation grille or roof vent is obstructed. ► Check that the required clearances for the air inlet vent and air outlet vent have been maintained during installation.
	The door seals are damaged or have slipped.	► Check the door seals for damage and correct fit.
	The fan is defective.	► Replace the fan.
	The control sensor is defective.	► Contact an authorized service agent.
	The temperature at the compressor is too low (<0 °C).	► Close/cover all external ventilation grilles completely with insulation material.
	The evaporator is iced up.	<ul style="list-style-type: none"> ► Check whether the refrigerator door is closed properly and the seals are not damaged. ► Defrost the refrigerator.
	The condenser is dirty.	► Clean the condenser.
	The ambient temperature is too high.	<ul style="list-style-type: none"> ► Temporarily remove the ventilation grille to allow the warm air to escape more quickly. ► Ensure a lower ambient temperature.
	Too much foodstuff was placed in the refrigerator at once.	► Reduce the contents of the refrigerator.
	Too many hot foods were placed in the refrigerator at once.	► Remove the warm food and leave it to cool down before putting it in again.
	The refrigerator has not been in operation for very long.	► Check the temperature again after 4–5 hours.
Water leaks into the inside of the refrigerator.	The water drainage system is blocked by foodstuff.	► Remove the blocking foodstuff.
	The water drainage system is clogged with dirt.	► Remove any dirt from the drain opening and the drain pipe.
Water leaks onto the floor.	The water drain hose is damaged.	► Check the drain water hose for leaks. Repair the hose or replace it if necessary.
	The water drain hose is not routed outside the vehicle.	► Route the hose to the outside of the vehicle (see chapter "Installing the drain water hose" on page 23).

Problem	Possible cause	Suggested remedy
Unusual noises (e.g. loud humming)	A component of the refrigerant circuit cannot move freely (touching the wall).	► Bend the component carefully away from the obstruction.
	A foreign object is located between the cooling unit and the wall.	► Remove the foreign object.

12.1 DC operation only

Problem	Possible cause	Suggested remedy
The refrigerator does not work. The display does not light up.	Insulation faults, corrosion, breaks or loose connections between the battery and electronics unit.	► Check connections and live cables for insulation faults, corrosion, breaks or loose connections.
	Main switch defective (if installed).	► Replace the main switch.
	Internal fuse has blown.	► Replace the internal fuse.
	The fuse in the DC cable is defective.	The fuse on the relay must be replaced. ► Contact an authorized service agent.
	The vehicle fuse has blown.	► Replace the vehicle fuse. Refer to the operating manual of your vehicle.
	The ignition is not switched on.	► Switch on the ignition.
	The vehicle battery is discharged.	► Charge the vehicle battery.
The refrigerator does not cool.	Internal error or defective components.	► Contact an authorized service agent.
	The battery capacity is too low.	► Replace the battery.
	The refrigerator is not connected correctly.	► Check the connections (see chapter "Connecting the refrigerator to DC power supply" on page 26). ► Check the cable cross-sections and lengths (fig. 21, page 26).

12.2 AC operation only

Problem	Possible cause	Suggested remedy
The refrigerator does not work. The display does not light up.	The vehicle is not connected to the AC power supply.	➤ Connect the vehicle to the AC power supply.
	Main switch defective (if installed).	➤ Replace the main switch.
	Internal fuse has blown.	➤ Replace the internal fuse.
	The fuse in the AC cable is defective.	➤ Contact an authorized service agent.
	The integrated mains adapter is defective.	➤ Contact an authorized service agent.
	Internal error or defective components.	➤ Contact an authorized service agent.

12.3 Faults and beeps

All faults are indicated on the display by highlighting the middle submenu on the main menu with a red banner and a code (error screen, see fig. 6 B, page 17).

Faults that terminate the entire cooling function are additionally indicated by a beep. The beep will last for 2 minutes and repeat every 30 minutes until the fault is cleared.

If several faults occur, the display shows the last fault that occurred. After the fault has been cleared, subsequent faults are displayed.

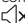
- Press the control knob for 2 – 4 seconds to confirm a fault.
- Press the  button in the settings menu (see chapter “Settings menu” on page 14) to mute the beep.

WARNING type fault messages

All faults of the WARNING type are reset automatically once the fault has been rectified.

Error message	Fault	Solution
01	Defrost NTC sensor error	➤ Replace the defrost NTC sensor.
02	Refrigerator air NTC sensor error	➤ Replace the refrigerator air NTC sensor.
10 + icon flashing and a beep	The refrigerator door is opened for more than 2 minutes.	➤ Close the refrigerator door.
11	DC undervoltage (<7.5 V) or overvoltage (>31.5 V)	➤ Check the DC supply voltage.
14	Internal fan defective Cooling operation is continued with a fixed thermostat setting.	➤ Contact an authorized service agent.
17	Low current at the defrost heater (<1 A)	<ul style="list-style-type: none"> ➤ Switch the refrigerator off and on again. ➤ Contact an authorized service agent if this error occurs again.

Error message	Fault	Solution
19	Input voltage outside the ABS setting range	<ul style="list-style-type: none"> ➤ Charge the vehicle battery. ➤ Switch on the ignition.
26	Ambient thermostat sensor error	<ul style="list-style-type: none"> ➤ Switch the refrigerator off and on again. ➤ Contact an authorized service agent if this error occurs again.

ERROR type fault messages

All faults of the ERROR type must be reset manually:

- Press and hold the control knob between 2 and 4 seconds.
- ✓ The error has been reset.

Error message	Fault	Solution
03	No communication between power module and display; operation is continued with the last saved settings	<ul style="list-style-type: none"> ➤ Contact an authorized service agent.
18	Over current protection of the defrost heater; defrost heater is turned off	<ul style="list-style-type: none"> ➤ Reset the error. ➤ Contact an authorized service agent if this error occurs again.
32 + a beep	Over current protection of the outer fan	<ul style="list-style-type: none"> ➤ Reset the error. ➤ Contact an authorized service agent if this error occurs again.
33 + a beep	Compressor does not start	<ul style="list-style-type: none"> ➤ Reset the error. ➤ Contact an authorized service agent if this error occurs again.
34 + a beep	Compressor is overloaded	<ul style="list-style-type: none"> ➤ Reset the error. ➤ Contact an authorized service agent if this error occurs again.
35 + a beep	Thermal shutdown of the control unit	<ul style="list-style-type: none"> ➤ Reset the error. ➤ Contact an authorized service agent if this error occurs again.

13 Warranty

If the product does not work as it should, please contact your retailer or the manufacturer's branch in your country (see dometic.com/dealer). The warranty applicable to your product is 3 year(s).

For repair and warranty processing, please include the following documents when you send in the device:

- A copy of the receipt with purchasing date
- A reason for the claim or description of the fault

Australia only

Our goods come with guarantees that cannot be excluded under the Australian Consumer Law. You are entitled to a replacement or refund for a major failure and for compensation for any other reasonably foreseeable loss or damage. You are also entitled to have the goods repaired or replaced if the goods fail to be of acceptable quality and the failure does not amount to a major failure.

New Zealand only

This warranty policy is subject to the conditions and guarantees which are mandatory as implied by the Consumer Guarantees Act 1993(NZ).

Local support

Please find local support at the following link address: dometic.com/dealer

14 Disposal**WARNING! Fire hazard**

- The refrigerant used is highly flammable. Do not open or damage the refrigerant circuit.
- The insulation of the device contains flammable cyclopentane (see data plate). Do not damage the insulation.



- Place the packaging material in the appropriate recycling waste bins wherever possible.
- Consult a local recycling center or specialist dealer for details about how to dispose of the product in accordance with the applicable disposal regulations.

15 Technical data

This product contains fluorinated greenhouse gases.

The cooling unit is hermetically sealed.

	RUC5208X	RUC6408X	RUC8408X
Capacity			
• Refrigerator compartment	133 l	134 l	170 l
• Frozen compartment	13 l	46 l	46 l
• Total capacity	146 l	180 l	216 l
Connection voltage	100 – 240 V~, 50 / 60 Hz 12 V==/24 V==		
Supply battery protection (12 V)			
• Cut-off voltage	10.4 V		
• Cut-in voltage	11.7 V		
Supply battery protection (24 V)			
• Cut-off voltage	22.8 V		
• Cut-in voltage	24.2 V		
Power consumption	75 W		
Rated current			
• 100 V~	1.0 A	1.0 A	1.3 A
• 240 V~	0.45 A	0.45 A	0.55 A
• 12 V==	9.0 A	9.2 A	10.5 A
• 24 V==	3.9 A	4.0 A	5.0 A
Refrigerant	R134a		
Refrigerant quantity	49 g	71 g	72 g
Cooling temperature range			
• Refrigerator compartment	0 °C to +8 °C	0 °C to +8 °C	0 °C to +8 °C
• Frozen compartment	-20 °C to -10 °C	-20 °C to -10 °C	-17 °C to -10 °C
Climate class	T		
Intended ambient temperature for use	+16 °C to +43 °C		
Noise emission	≤47 dB		

	RUC 5208X	RUC 6408X	RUC 8408X
Dimensions H x W			
• With flange	1191 x 550 mm	1447 x 550 mm	1657 x 550 mm
• Without flange	1178 x 525 mm	1434 x 525 mm	1644 x 525 mm
• Depth (overall, excluding control knob with 5 mm)	677 mm	677 mm	677 mm
• Depth (from flange rear face)	611 mm	611 mm	611 mm
Weight	43 kg	48 kg	52 kg
Maximum load	3 kg 4.5 kg 10.5 kg		
Inspection/certification			

dometic.com

**YOUR LOCAL
DEALER**

dometic.com/dealer

**YOUR LOCAL
SUPPORT**

dometic.com/contact

**YOUR LOCAL
SALES OFFICE**

dometic.com/sales-offices
